

2nd Supervisorial District - Janet Wolf, Supervisor

Population: 84,447. Land Area approximately 73 sq. miles
 Santa Barbara County Ordinance No. 4797 effective September 8, 2011. Compiled by the County Surveyor's Office in October 2011

Population Data Source: U.S. Census Data 2010.
 Disclaimer: This map is a graphic representation and is for reference only. District lines as shown on this map have been modified to fit the parcelized base map created and provided by the County Assessor's Office. No level of accuracy is claimed for the district line shown hereon and lines should not be used to obtain coordinate values, distances, or bearings. Although every effort has been made to ensure the accuracy of information, errors and conditions originating from physical sources used to develop the database may be reflected in this data. Santa Barbara County shall not be liable for any errors, omissions, or damages that result from inappropriate use of this document.

District 2
 Population: 84,447
 Land Area: 73
 Ocean Area: 33

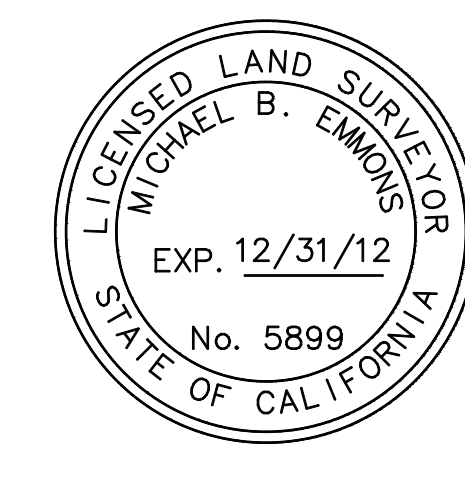
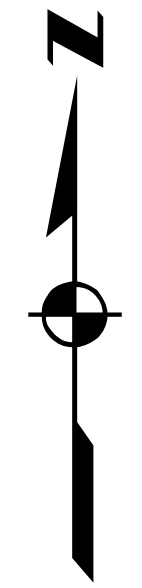
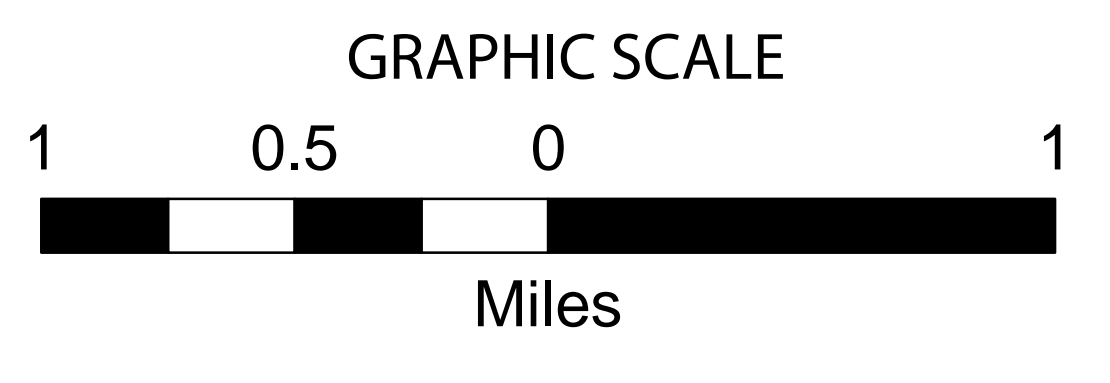

County Surveyor's Certificate
 THIS MAP WAS PREPARED UNDER MY DIRECTION IN ACCORDANCE WITH CALIFORNIA GOVERNMENT CODE SECTION 27557, IN OCTOBER 2011. I CERTIFY THE DISTRICT LINES SHOWN HEREON ARE CONSISTENT WITH COUNTY ORDINANCE #4797, EFFECTIVE SEPTEMBER 8, 2011.
 Michael B. Emmons
 MICHAEL B. EMMONS
 COUNTY SURVEYOR
 10/26/2011
 DATE

