

UNITED STATES
DEPARTMENT OF THE INTERIOR
BUREAU OF LAND MANAGEMENT

ORIGINAL

FIELD NOTES
OF
THE REMONUMENTATION OF
A SPECIAL MEANDER CORNER IN SECTION 34,
IN
TOWNSHIP 10 NORTH, RANGE 36 WEST,
OF THE
SAN BERNARDINO MERIDIAN,
IN THE STATE OF CALIFORNIA.

EXECUTED BY

Gregory J. Aten, Cadastral Surveyor

Under Special Instructions dated and approved August 6, 1998,
and Assignment Instructions dated and approved November 29, 2007,
which provided for the remonumentation included
under Group No. 1290, California.

Survey commenced June 13, 2007

Survey completed June 13, 2007

INDEX DIAGRAM

TOWNSHIP 10 NORTH, RANGE 36 WEST, S.B.M.

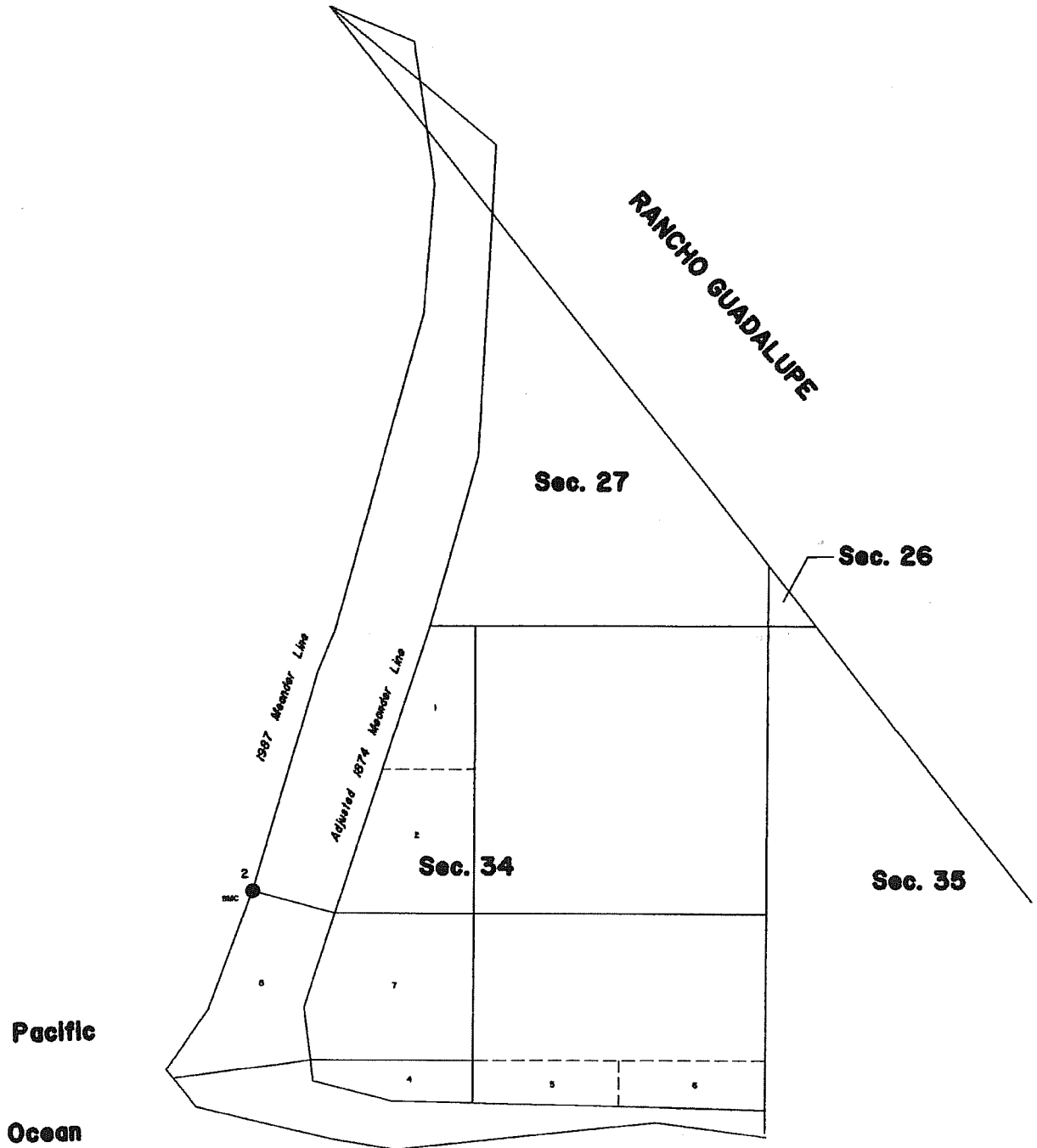

T. 10 N., R. 36 W., San Bernardino Meridian, California

The following field notes describe the remonumentation of a special meander corner in section 34, Township 10 North, Range 36 West, San Bernardino Meridian, California.

History of pertinent surveys

1985-88 - Roger J. Mercer, Supervisory Cadastral Surveyor, and Douglas J. Jacobson, Cadastral Surveyor, dependently resurveyed the boundaries of fractional section 34, and a portion of the 1874 meander line along the Pacific Ocean. They also surveyed the subdivision of section 34 and the 1987 meander line along the Pacific Ocean under Group No. 931.

The remonumentation of this corner was performed in accordance with the specifications as set forth in the Manual of Surveying Instructions, 1973 edition, and Special Instructions dated August 6, 1998, for Group No. 1290, California.

The remonumentation was executed at the request of Dan Vaughn, Realty Specialist, Bakersfield Field Office, for the purpose of protecting archaeological and natural resources on the public lands in section 34, Township 10 North, Range 36 West, San Bernardino Meridian, California.

The special meander corner being remonumented was originally established during the 1985-88 survey, at a point N. $72^{\circ}13'55''$ W., 11.897 chs. dist. from the special meander corner located at the intersection of the E and W center line of section 34, with the adjusted 1874 meander line. The brass tablet set during the 1985-88 survey has been removed by vandals; the drill hole in which the brass tablet was set is the only remaining evidence of the corner.

Preliminary to the remonumentation, the position of the drill hole was verified by survey ties to the following corners: (1) the special meander corner recovered at the intersection of the E and W center line of section 34, with the 1874 meander line, and (2) the special meander corner recovered at the intersection of the E and W center line of the SW 1/4 of section 34, with the adjusted 1874 meander line. The record position of these corners were found to be within 3 tenths of a foot relative to the drill hole found at the special meander corner. Real Time Kinematic GPS techniques were used to verify the positions of the previously mentioned corners.

Remonumentation of a Special Meander Corner in Section 34,
T. 10 N., R. 36 W., San Bernardino Meridian, California

Remonumenting a corner established by
Roger J. Mercer and Douglas J. Jacobson, in 1985-88

The special meander corner, on a partition line normal to the adjusted 1874 meander line, at intersection with the 1987 meander line along the Pacific Ocean, monumented with a drill hole (in which the brass tablet set in the 1985-88 survey had originally been set) in the nearly level top of an outcropping of rock, approximately 10 ft. above sea level.

At the corner point

Set a brass tablet, 3 1/4 ins. diam., 3 1/2 in. stem, in marine epoxy in the drill hole used in the 1985-88 survey, with top marked.

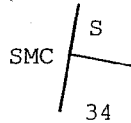

2007

Note: A marine epoxy was used because it is a more permanent adhesive material.

Corner is located on the nearly flat surface of an outcropping of rock, approximately 10 ft. above sea level, at the base of a sandy bluff.

FIELD ASSISTANTSBUREAU OF LAND MANAGEMENT PERSONNEL

Thomas J. Fusek	Survey Technician
Thomas E. Jermin III	Survey Technician
Catherine V. Aten	Survey Technician
Daniel Vaughn	Realty Specialist

CERTIFICATE OF SURVEY

I, Gregory J. Aten, HEREBY CERTIFY upon honor that, in pursuance of Special Instructions bearing date of the 6th day of August, 1998, for Group No. 1290, I have executed the remonumentation of a special meander corner in section 34, Township 10 North, Range 36 West, of the San Bernardino Meridian, California, which are represented in the foregoing field notes as having been executed by me and under my direction; and that said remonumentation has been made in strict conformity with said Special Instructions, the *Manual of Instructions for the Survey of the Public Lands of the United States*, and in specific manner described in the foregoing field notes.

2-04-2008

(Date)

Gregory J. Aten
(Cadastral Surveyor)

CERTIFICATE OF APPROVAL

BUREAU OF LAND MANAGEMENT
Sacramento, California

The foregoing field notes of the remonumentation of a special meander corner in section 34, Township 10 North, Range 36 West, of the San Bernardino Meridian, California, executed by Gregory J. Aten, Cadastral Surveyor, having been critically examined and found correct, are hereby approved.

February 7, 2008
(Date)

James F. Puley
(Chief Cadastral Surveyor - California)