

Township No 8 North, Range No 27 West, San Bernardino Meridian.

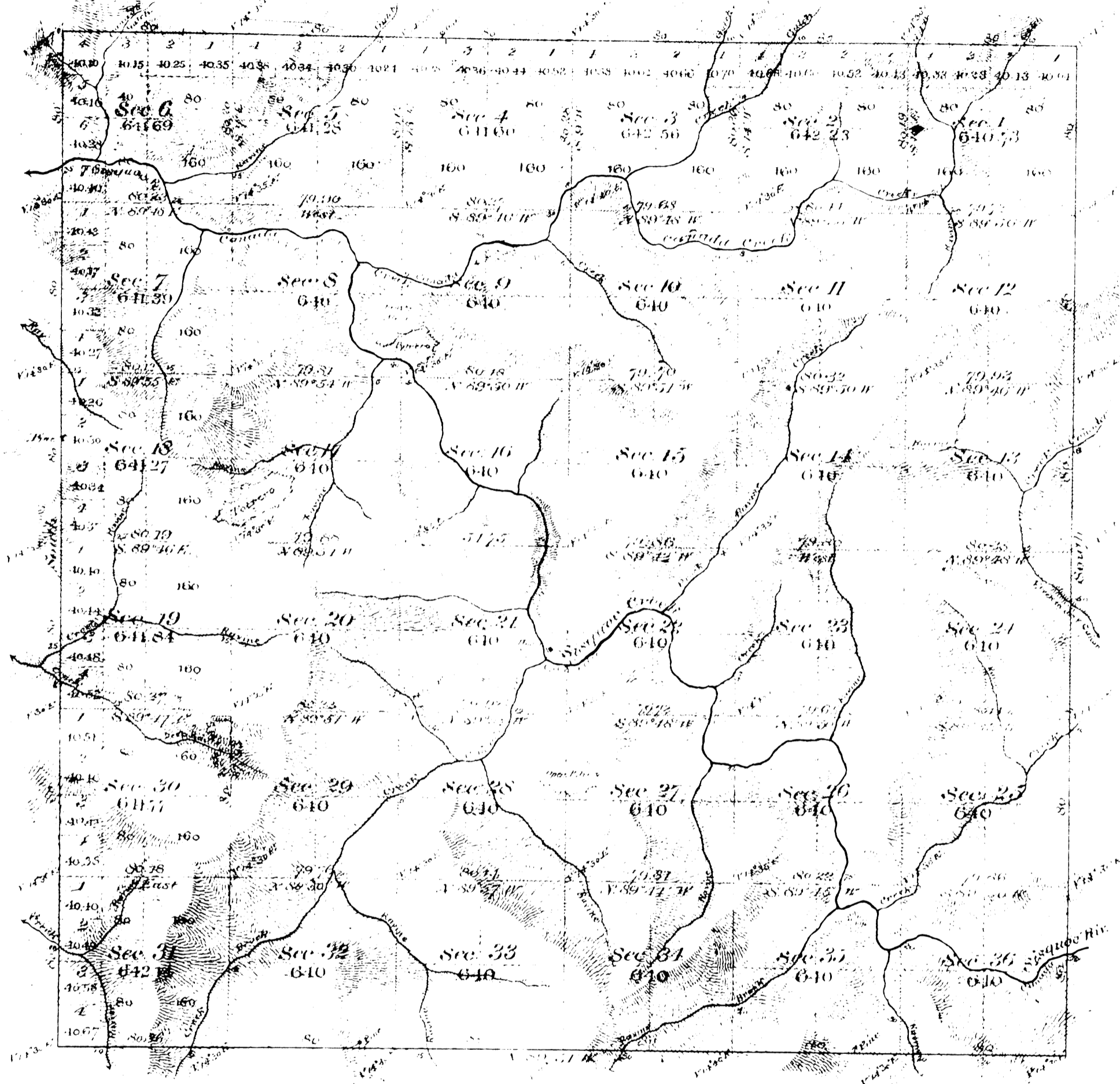

Approved by the Surveyor General

Survey Disputed by the Surveyor General, California, in 1881.
 North boundary of Bunker Hill, California, in 1881.
 West of Town of Loma Linda, California, in 1881.
 Section No. 1, 2, 3, 4, 5, 6, 7, 8, 9, 10, 11, 12, 13, 14, 15, 16, 17, 18, 19, 20, 21, 22, 23, 24, 25, 26, 27, 28, 29, 30, 31, 32, 33, 34, 35, 36.

This map of the Township No 8 North, Range No 27 West, San Bernardino Meridian, is strictly conformable to the field notes of the Survey thereon, and the same which have been examined and approved.
 Surveyor General's Office
 San Francisco, California
 December 25th 1881

E. M. Brown

San Fran Cal