

Township N° 8 North Range N° 29 West San Bernardino Meridian.

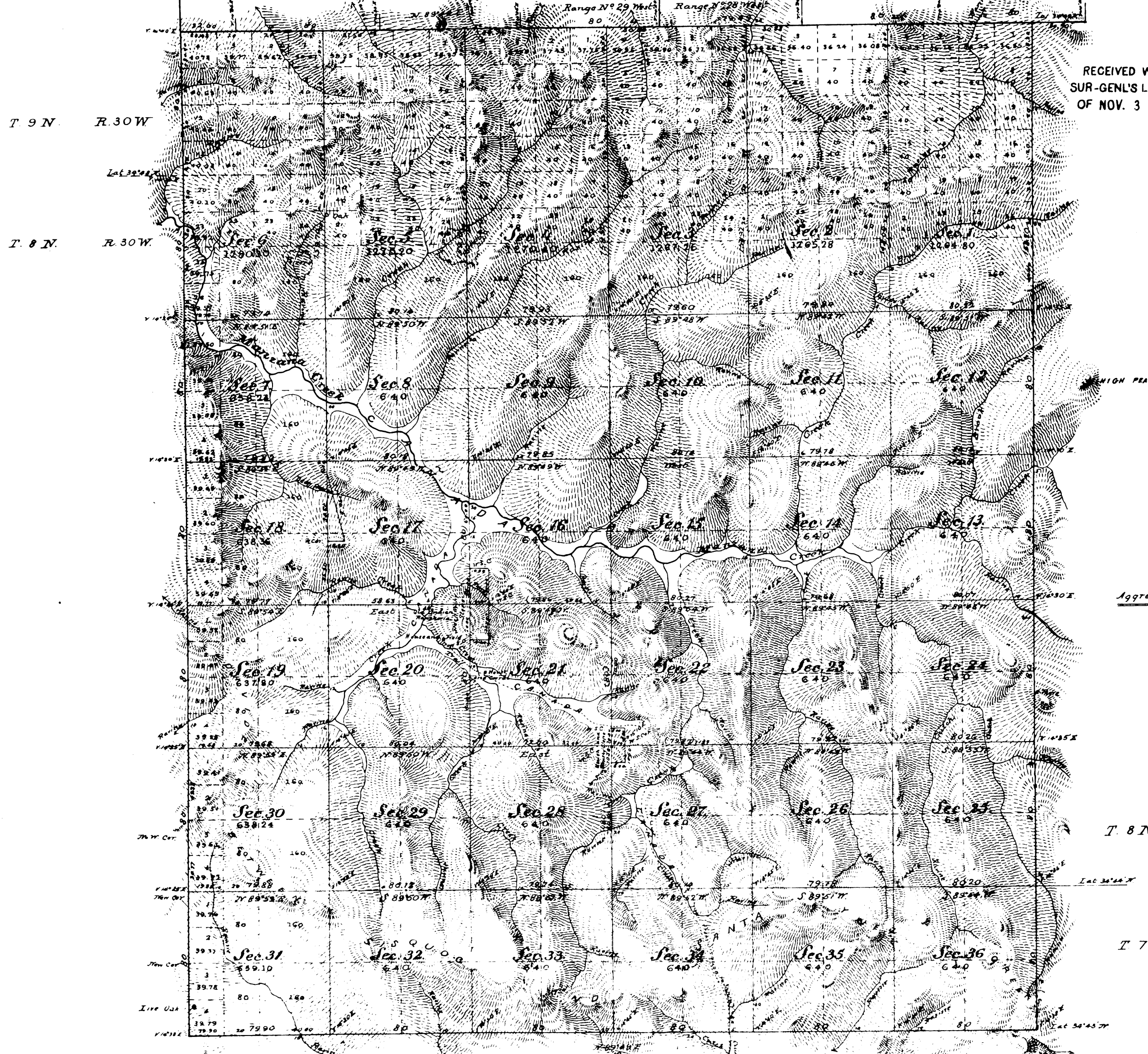

RECEIVED WITH
SUR-GEN'L'S LETTER
OF NOV. 3 1882

Aggregate Area of Public Land 26,849 Acres

T 8 N R 28 W

T 7 N R 28 W

Surveys Designated	By whom Surveyed	Date of Contract	Amount of Survey	When Surveyed	Mean Declination
Line of 1/4th boundary of Township (solid blue)	H. W. Vail	December 8th 1857	Miss. 1/4th 1.00	1858	14° 40' East
Township line (solid blue)	J. H. Colver	January 26th 1860	1.00	1861	
Section lines (solid blue)	G. S. Collins	April 7th 1862	64 24 95	1862	
Connecting lines (dashed red)			1 75 04	June 10th 1862	

The above Map of Township N° 8 North, Range N° 29 West, San Bernardino Meridian, is a study conformable to the field notes of the surveys therein, on file in the office of the Surveyor General's Office, San Francisco, California, November 2nd 1882.

W. H. B.
 Surveyor General