

Township N^o 9 North, Range N^o 36 West, San Bernardino Meridian.

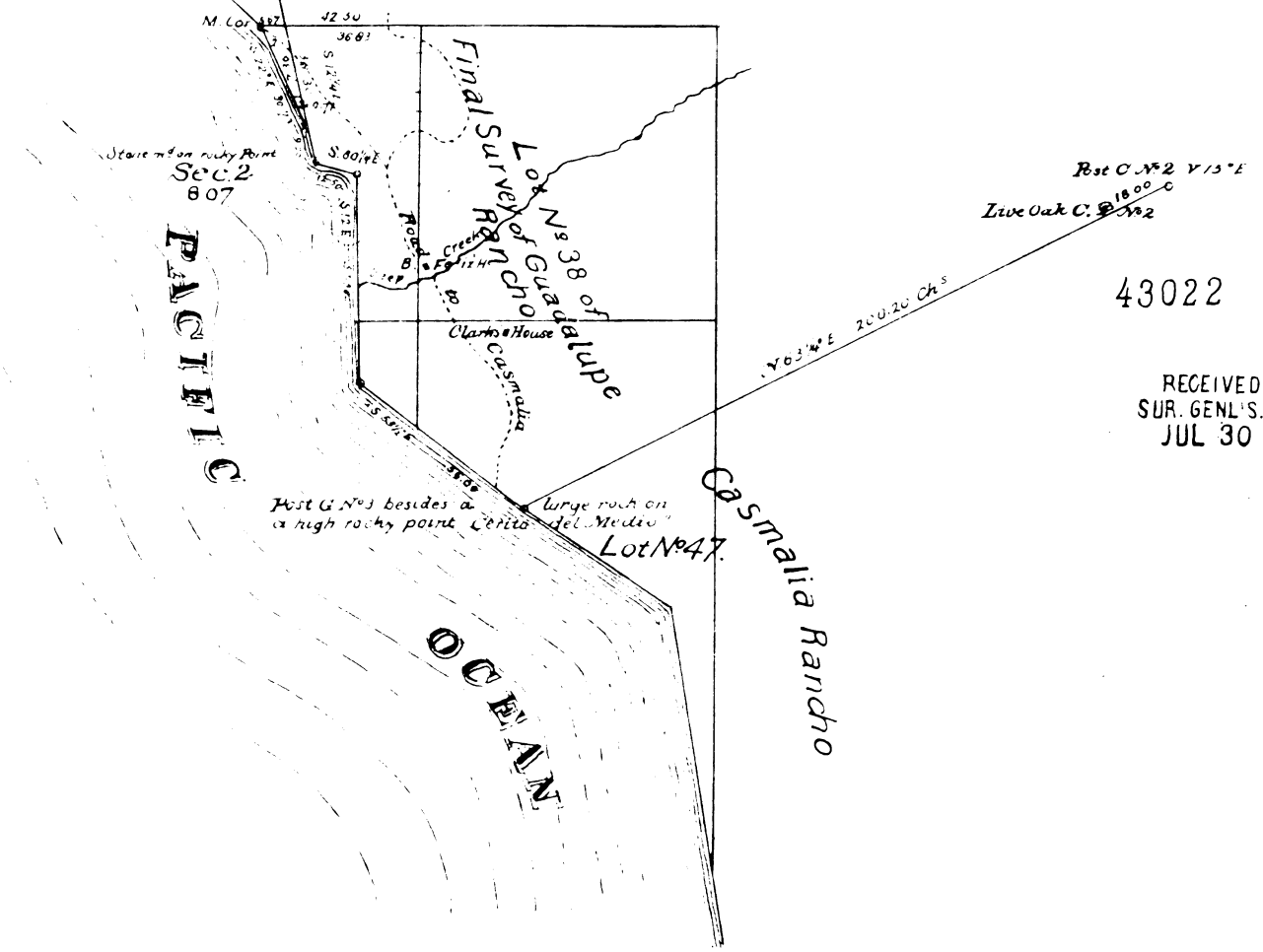

RECEIVED WITH
SUR. GEN'L'S LETTER.
JUL 30 1884

Aggregate Area of Public Land 8.07 Acres
Estimated Private Grants 1,404.39
Aggregate 1,412.39

Surveys Designated	By Whom Surveyed	Date of Contract	Amount of Surveys	When Surveyed	Meridian
For Surveys already established:	see Map of this Township as approved	October 26 th 1874.			
Boundaries of Lot No. 47 shaded green	C. H. Thompson	February 6 th 1887		February 1887	
All lines shaded red	W. H. Minto	December 21 st 1886	1,404.39	May 25 th 1887	S. East.

The above Map of Township N^o 9 North of Range N^o 36 West of San Bernardino Meridian is strictly conformable to the field notes of the surveys thereof on file in this Office, which have been examined and approved.

U. S. Surveyor General's Office
San Francisco, California,
July 29th 1884
W. H. Barren
U. S. Surv. Gen'l Cal.