

Township N. 10 North, Range N. 29 West, San Bernardino Meridian.

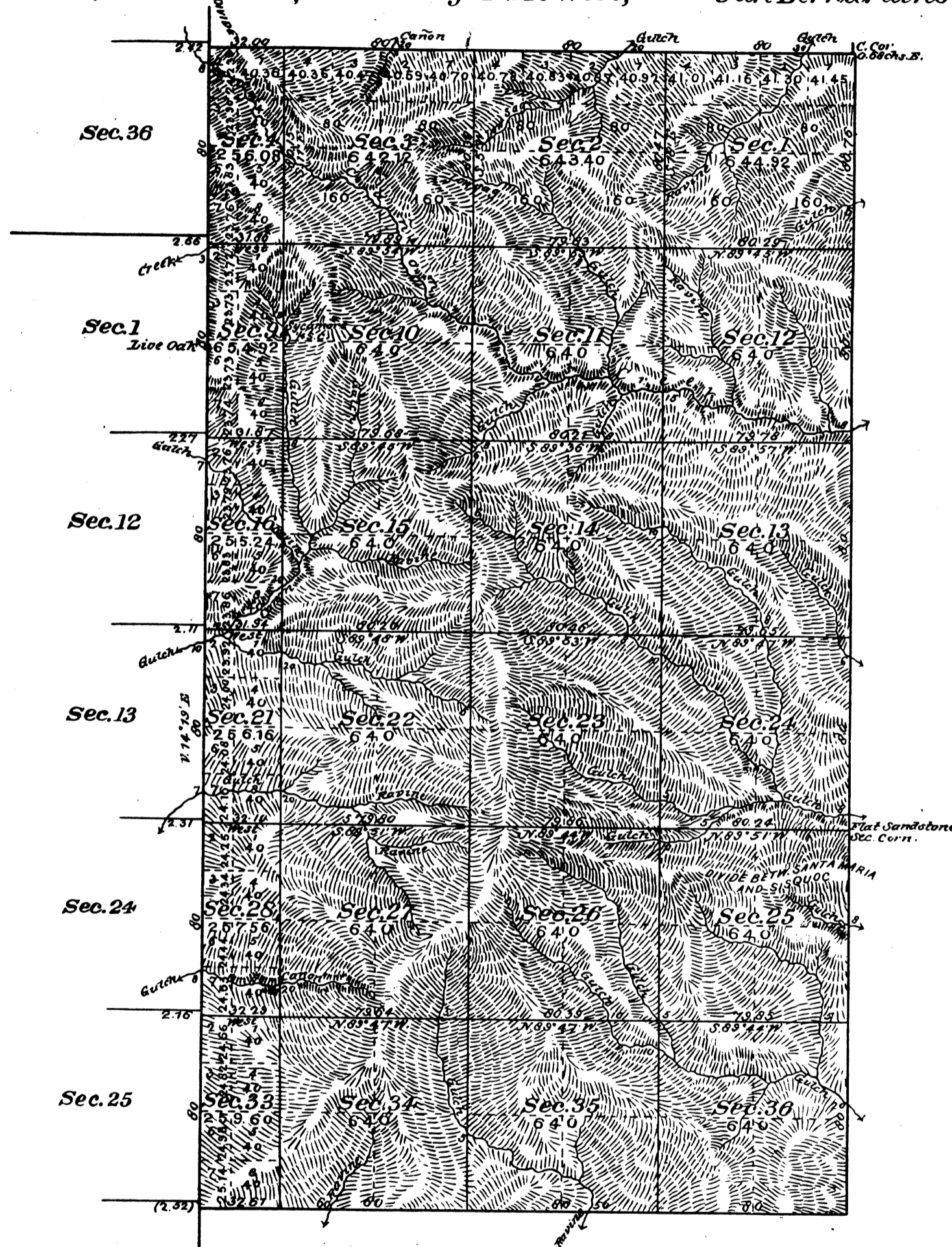

Rec'd with Sur. Genl. letter, May 8, 1895

Aggregate Area of Public Land. 13,070.00 Acres

Survey designated	By whom surveyed	Date of Contract	Amount of Surveys	When surveyed	Mean Decl.
South Bay of Township	J. R. Glover	January 26 th 1880	chrgd. inform acct.	1887	14° 30' East
East	"	"	6 mls. Ochs. 767A's	1883	
North	"	"	3 . 32 . 00	1883	
West	"	"	"	1883	
Section lines	"	"	35 . 0 . 83	1883	
Connecting lines	"	"	0 . 14 . 55	June 25 th 1893	

The above map of Township N. 10 North, Range N. 29 West, San Bernardino Meridian, is strictly conformable to the field notes of the surveys, thereof, on file in this office, which have been examined and approved.
 Surveyor General's Office,
 San Francisco, California
 May 8th 1895

W. H. Brown
 Sur. Gen. Cal.