

Township N<sup>o</sup> 10 North, Range N<sup>o</sup> 30 West, San Bernardino Meridian.

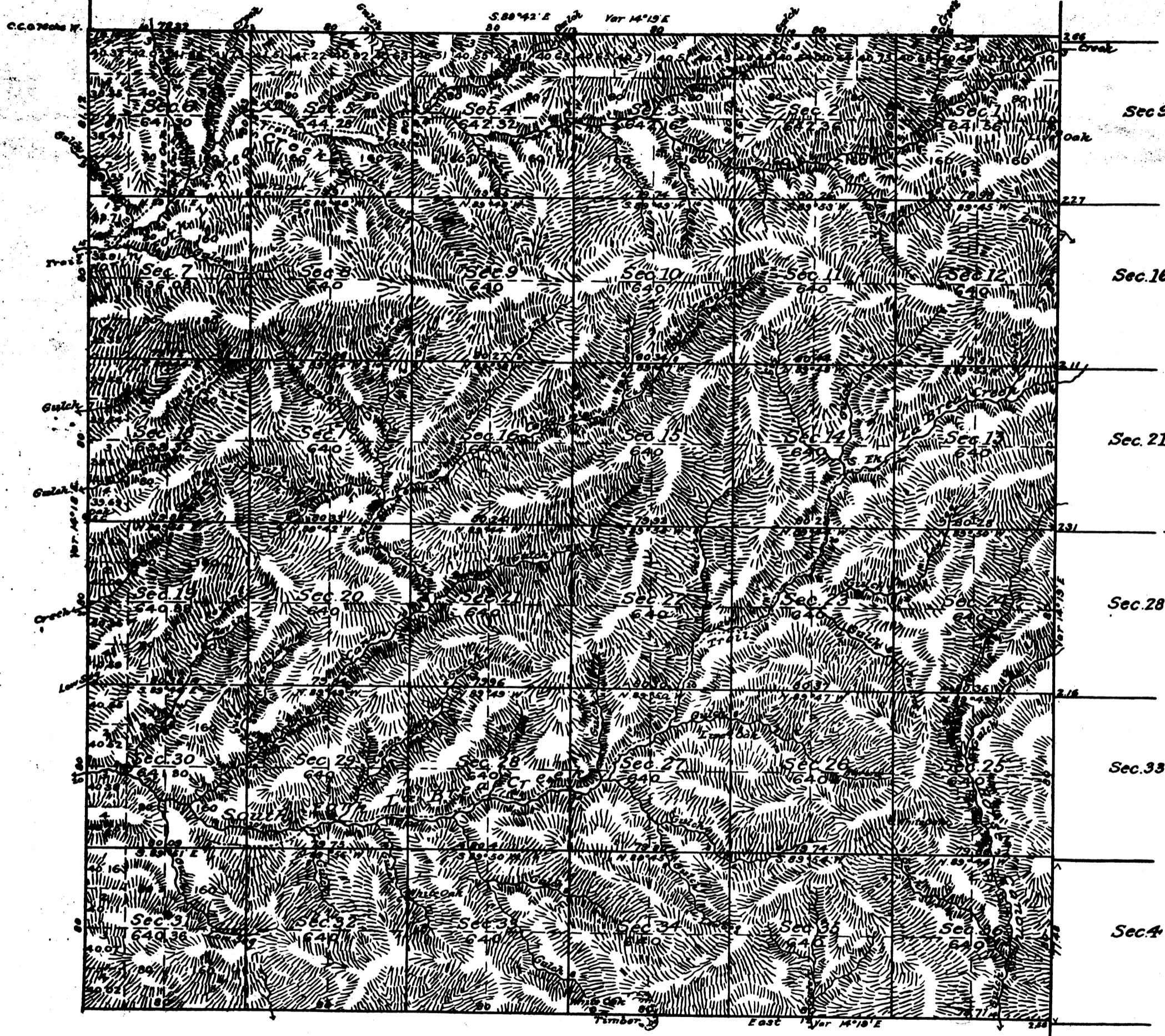

RECEIVED WITH  
SUR. GEN'L'S LETTER.  
MAY 8 1885  
44435

Aggregate Area of Public Land . . . 23,051.42 Acres

Surveys Designated	By whom surveyed	Date of Contract	Amount of surveys	When surveyed	Mean Declin.
Part of S.W. 1/4 of Tp.	J. R. Glover	January 26 <sup>th</sup> 1880	chg'd. in form. acct	1880	14° 19' East
East 1/2 of Tp.	"	"	6 mls. Qchs. 0 lks.	1883	
North	"	"	5 . 78 . 32 .	1883	
East of W. 1/2 of Tp.	"	"	5 . 1 . 32 .	1883	
" S	"	"	2 . 75 . 71 .	1883	
Section lines	"	"	60 . 3 . 2 .	1883	
Connecting lines	"	"	0 . 3 . 36 .	June 16 <sup>th</sup> 1883	

The above map of Township N<sup>o</sup> 10 North, Range N<sup>o</sup> 30 West, San Bernardino Meridian is strictly conformable to the field notes of the surveys hereof on file in this Office, which have been examined and approved.  
Surveyor General's Office,  
San Francisco, California,  
May 8<sup>th</sup> 1885.

*W. H. Brown*  
U.S. Sur. Gen. Cal.