

Township N<sup>o</sup> 11 North, Range N<sup>o</sup> 30 West, San Bernardino Meridian.

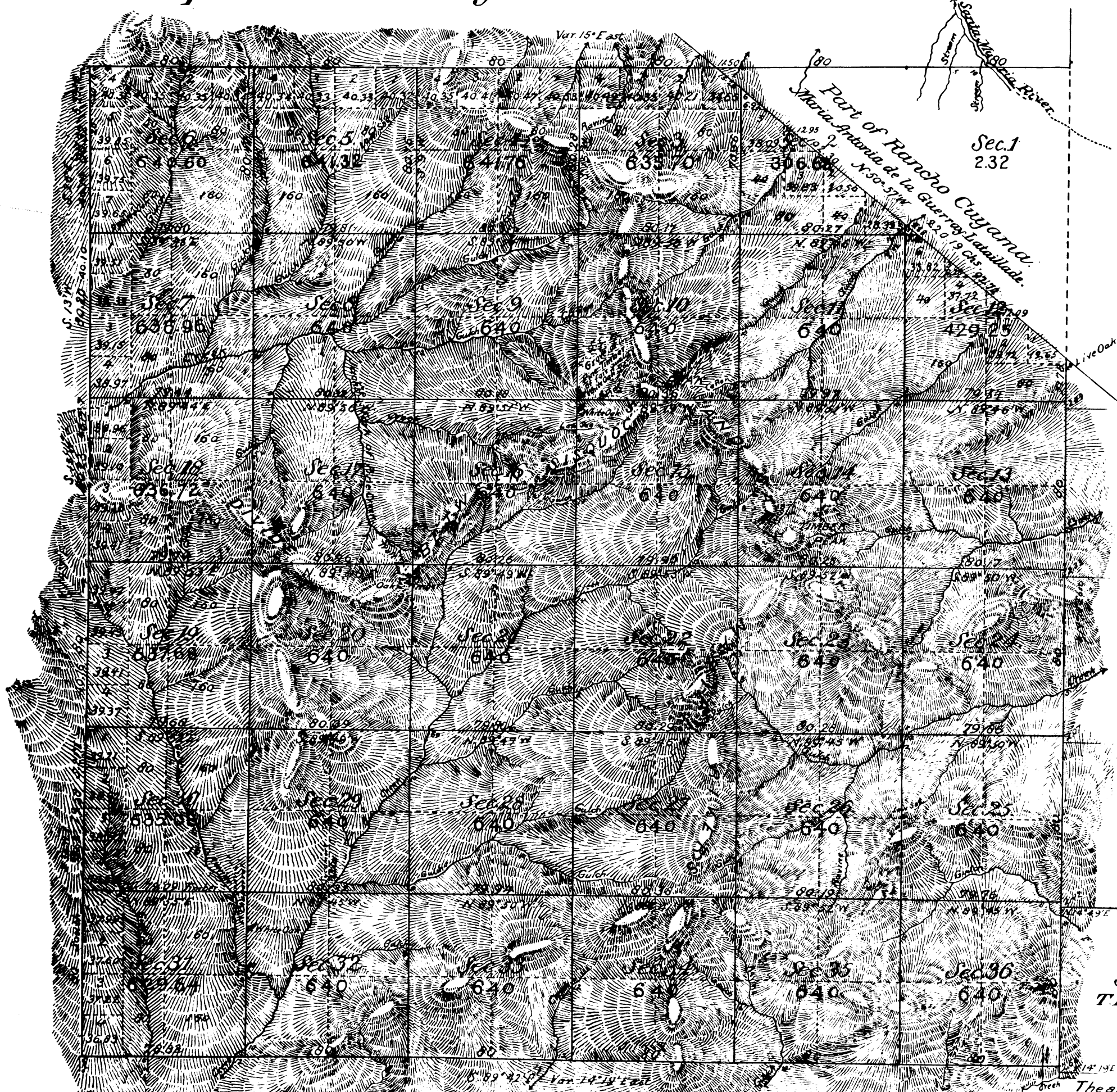

RECEIVED WITH  
SUR. GEN'L'S LETTER.  
MAY 8 1885  
44435.

Aggregate Area of Public Land	21,833.71 Acres
Estimated Lot N <sup>o</sup> 37	1,187.29
<u>Aggregate</u>	<u>23,021.00</u>

The above Map of Township N<sup>o</sup> 11 North, Range N<sup>o</sup> 30 West, San Bernardino Meridian, is strictly conformable to the field notes of the surveys thereof on file in this Office which have been examined and approved.

Surveyor General's Office  
San Francisco California.

May 8<sup>th</sup> 1885.

*W. H. Brown*  
U.S. Surv. Gen'l. Cal.

Surveys Designated	By Whom Surveyed	Date of Contract.	Amount of Surveys	When Surveyed	Mean Declination
West Boundary of Township	R. W. Norris	October 14 <sup>th</sup> 1858		1858	} 14° 19' East
Ranch Boundaries	R. R. Harris	Inst. May 23 <sup>rd</sup> 1872		1872	
North Bay of Township	J. R. Glover	January 26 <sup>th</sup> 1880		1880	
Ranch Bay re-surveyed			Charged in former <sup>ac</sup> cot	1880	
South of Township				1880	
East				1883	} 14° 7' East
West re-surveyed			4 Mls. 21chs. 78lks	1883	
Section Lines			6 - 0. 33 -	1883	
Connecting Lines			39 - 6. 14 -	1883	
			2 - 44. 90 -	June 9 <sup>th</sup> 1883.	} 14° 18' East