

Rec^d with Sur. Genl's letter of Nov. 4th 1881.
 Township N^o 12 North Range N^o 31 West San Bernardino Mer^o

Aggregate Area of Public Land 7531.80 acres

T. 32 S. R. 17 E. M. D. M.

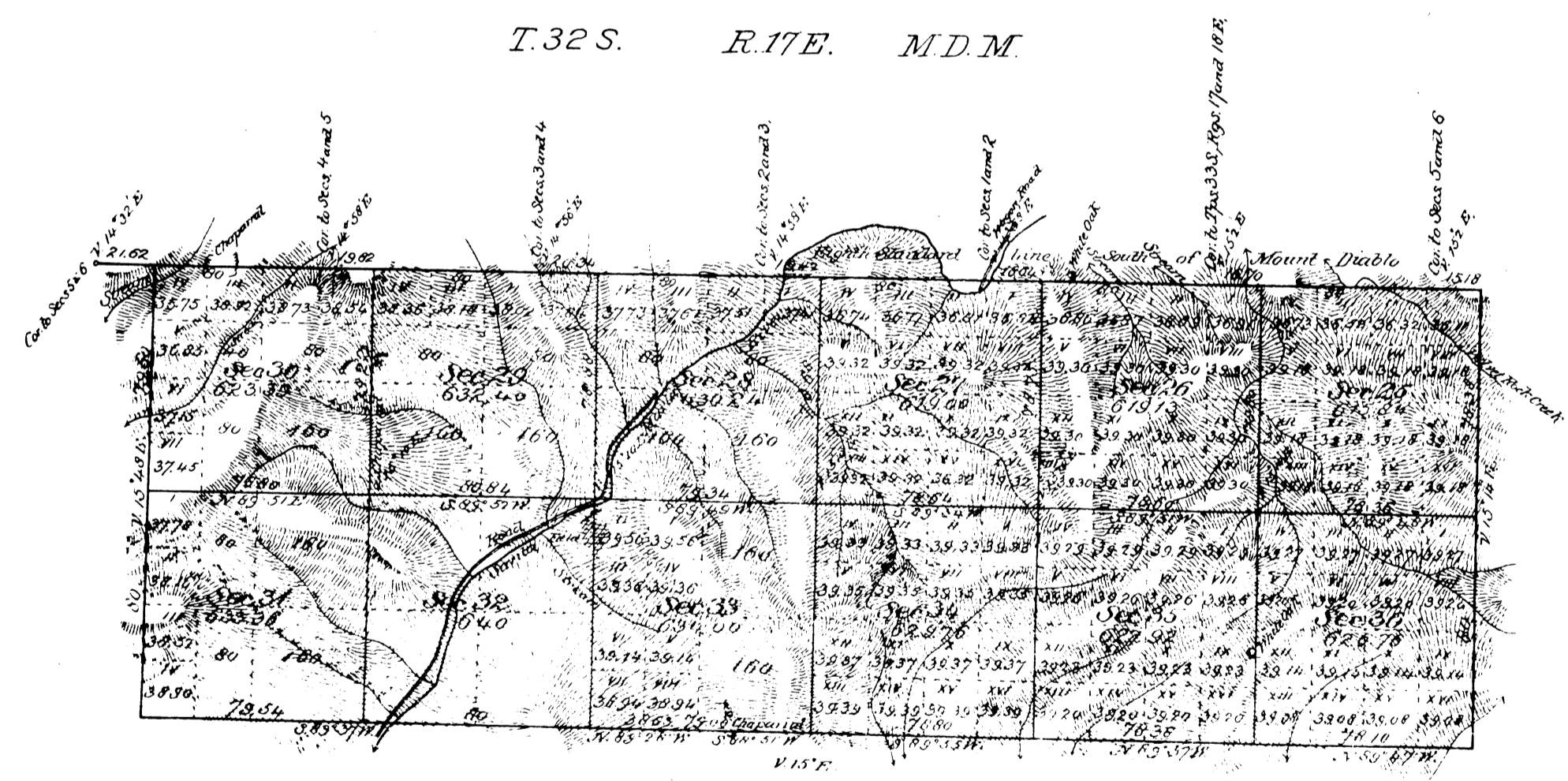

All the lines of this township pass over mountainous land

Surveys Designated	By Whom surveyed	Date of Control	Amount of Surveys	When Surveyed	Magn. Declination
South Boundary of Township North	H. W. Adams	October 14 th 1858		1858	
South Boundary of Tps. 12, 13, 14, 15, 16, 17, 18, 19, 20, 21, 22, 23, 24, 25, 26, 27, 28, 29, 30, 31, 32, 33, 34, 35, 36	J. R. Clark	January 26 th 1880	5167 7/8 Secs. 56 1/2	1880	14° 58' 13"
Rest of Township lines			3 73 82		15 "
Section lines			3 77 98		15 " 30 "
Connecting lines (red)			15 68 91		15 " 15 "
			1 31 10	July 5, 1880	

The above map of Township N^o 12 North, Range N^o 31 West, San Bernardino Meridian, is strictly conformable to the field notes of the surveys thereon file in this office, which have been examined and approved.

Surveyor General's Office
 San Francisco, California
 November 4th 1881

Chas. Wagner

Sur. Genl. Cal.

