

OLD FILE PLAN
PATENTS
 BOOK NO. **A**
 PAGE NO. **294**

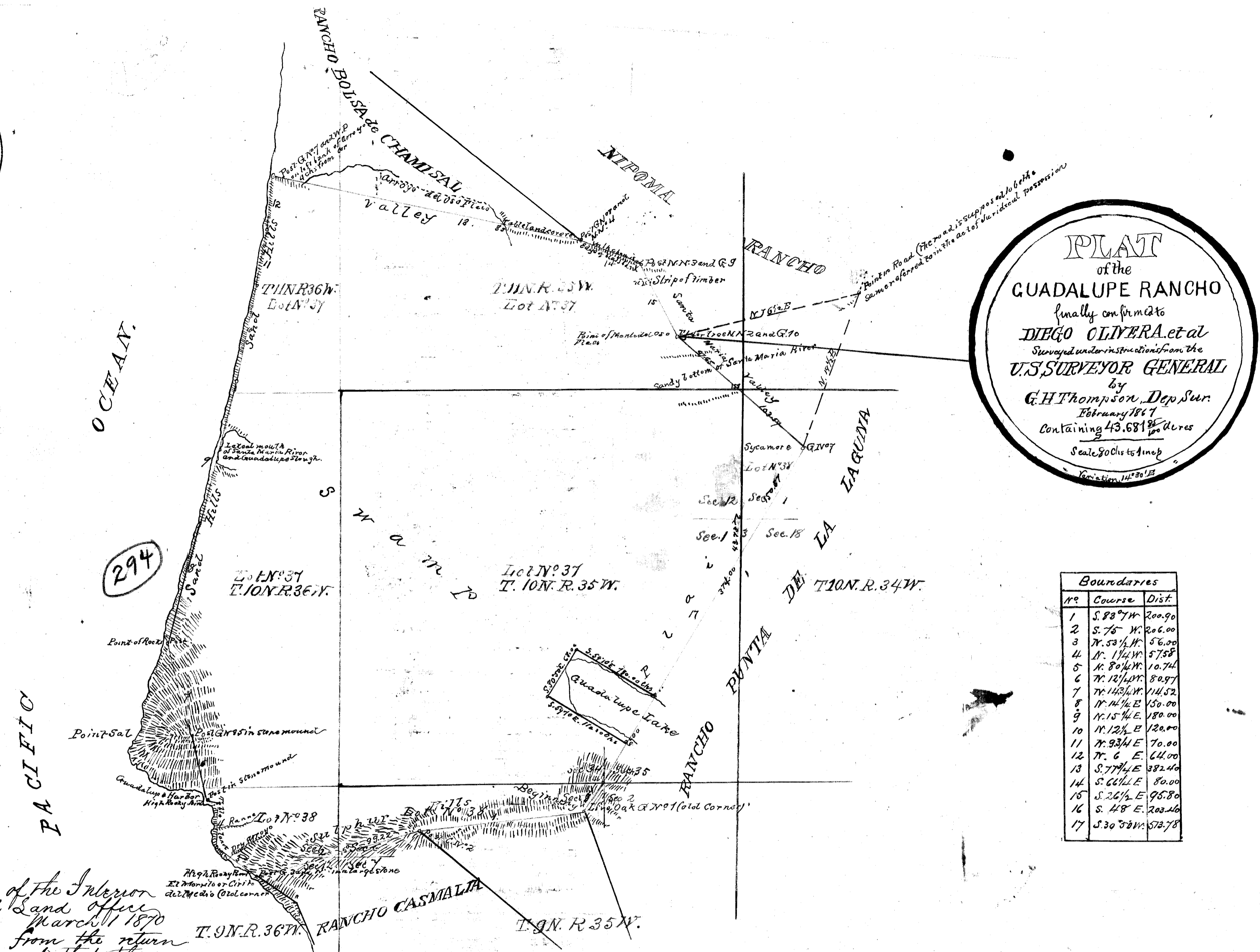

PLAT
 of the
GUADALUPE RANCHO
 finally confirmed to
DIEGO OLIVERA et al
 Surveyed under instructions from the
U.S. SURVEYOR GENERAL
 by
G.H. Thompson, Dep. Sur.
 February 1867
 Containing 43,681 ³⁸/₁₀₀ acres
 Scale 80 Chs to 1 in

Boundaries		
No.	Course	Dist.
1	S. 88° 7' W.	200.90
2	S. 75° W.	206.00
3	N. 53 1/2° W.	56.00
4	N. 1 1/4° W.	57.58
5	N. 80 1/4° W.	10.74
6	N. 12 1/4° W.	80.57
7	N. 143 1/4° W.	114.52
8	N. 14 1/4° E.	150.00
9	N. 15 1/4° E.	180.00
10	N. 12 1/2° E.	120.00
11	N. 93 1/4° E.	70.00
12	N. 6° E.	64.00
13	S. 77 1/4° E.	382.40
14	S. 66 1/2° E.	80.00
15	S. 26 1/2° E.	95.80
16	S. 48° E.	203.46
17	S. 30 3/4° W.	573.78

Department of the Interior
 General Land Office
 March 11 1870
 It appearing from the return
 of the Surveyor General that this survey
 is advertised for the period and remained
 without objection in the office of the said
 Surveyor General for the time specified in the Act
 of July 1st 1864 U.S. Statutes Vol. 13 page 332
 this survey is hereby approved

Approved March 11 1870
 G. S. Mearns
 Commissioner of the General Land Office

The field notes of the Guadalupe Rancho from which
 this Plat has been made, have been examined and
 approved and are on file in this Office
 U.S. Surveyor General's Office
 San Francisco, California
 June 29th 1867

L. P. Ripson
 U.S. Surveyor General

