

OLD FILE PLAN
PATENTS
BOOK NO. A
PAGE NO. 491

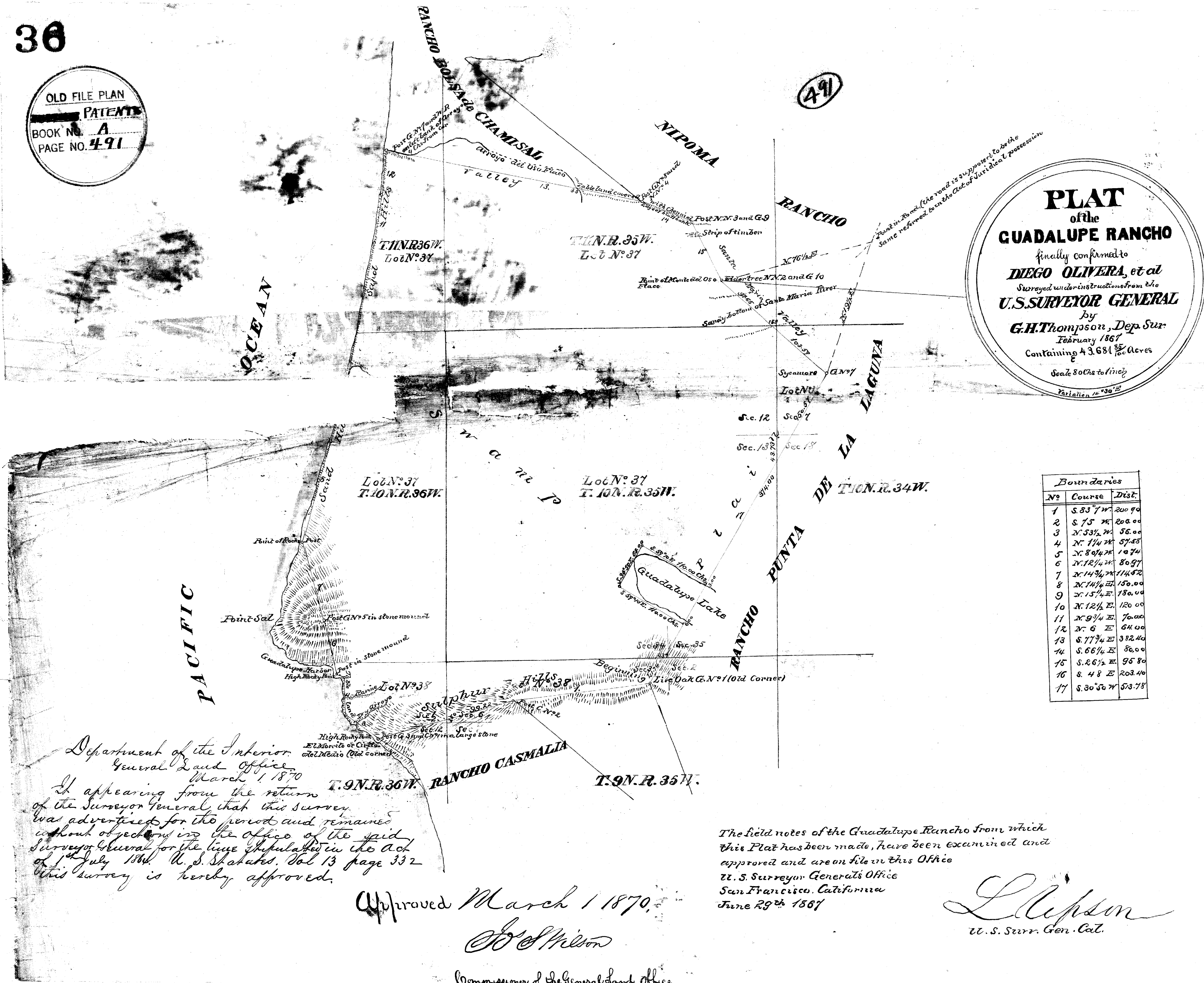

PLAT
of the
GUADALUPE RANCHO
finally confirmed to
DIEGO OLIVERA, et al
Surveyed under instructions from the
U.S. SURVEYOR GENERAL
by
G.H. Thompson, Dep. Sur.
February 1867
Containing 43,681 ⁸⁵/₁₀₀ Acres
Scale 80 Chs to 1 inch
Variation 14° 30' E

Boundaries		
Nº	Course	Dist.
1	S. 83 7/8 W.	200.90
2	S. 75 W.	200.00
3	N. 53 1/2 W.	56.00
4	N. 1 1/4 W.	57.48
5	N. 8 0/4 W.	10.74
6	N. 12 1/4 W.	80.97
7	N. 14 3/4 W.	114.52
8	N. 14 1/4 E.	150.00
9	N. 15 1/4 E.	180.00
10	N. 12 1/2 E.	120.00
11	N. 9 3/4 E.	70.00
12	N. 6 E.	64.00
13	S. 77 3/4 E.	332.40
14	S. 66 1/4 E.	80.00
15	S. 26 1/2 E.	95.80
16	S. 48 E.	203.40
17	S. 30 5/8 W.	53.78

Department of the Interior
General Land Office
March 1, 1870

It appearing from the return of the Surveyor General that this survey was advertised for the period and remained without objection in the office of the said Surveyor General for the time stipulated in the act of July 1864. U. S. Statutes, Vol 13 page 332 this survey is hereby approved.

Approved March 1 1870,

G. S. Wilson

Commissioner of the General Land Office.

The field notes of the Guadalupe Rancho from which this Plat has been made, have been examined and approved and are on file in this Office
U. S. Surveyor General's Office
San Francisco, California
June 29th 1867

L. S.
U. S. Survey. Gen. Cal.

L. S.