

OLD FILE PLAN
 Misc.
 BOOK NO. B
 PAGE NO. 426

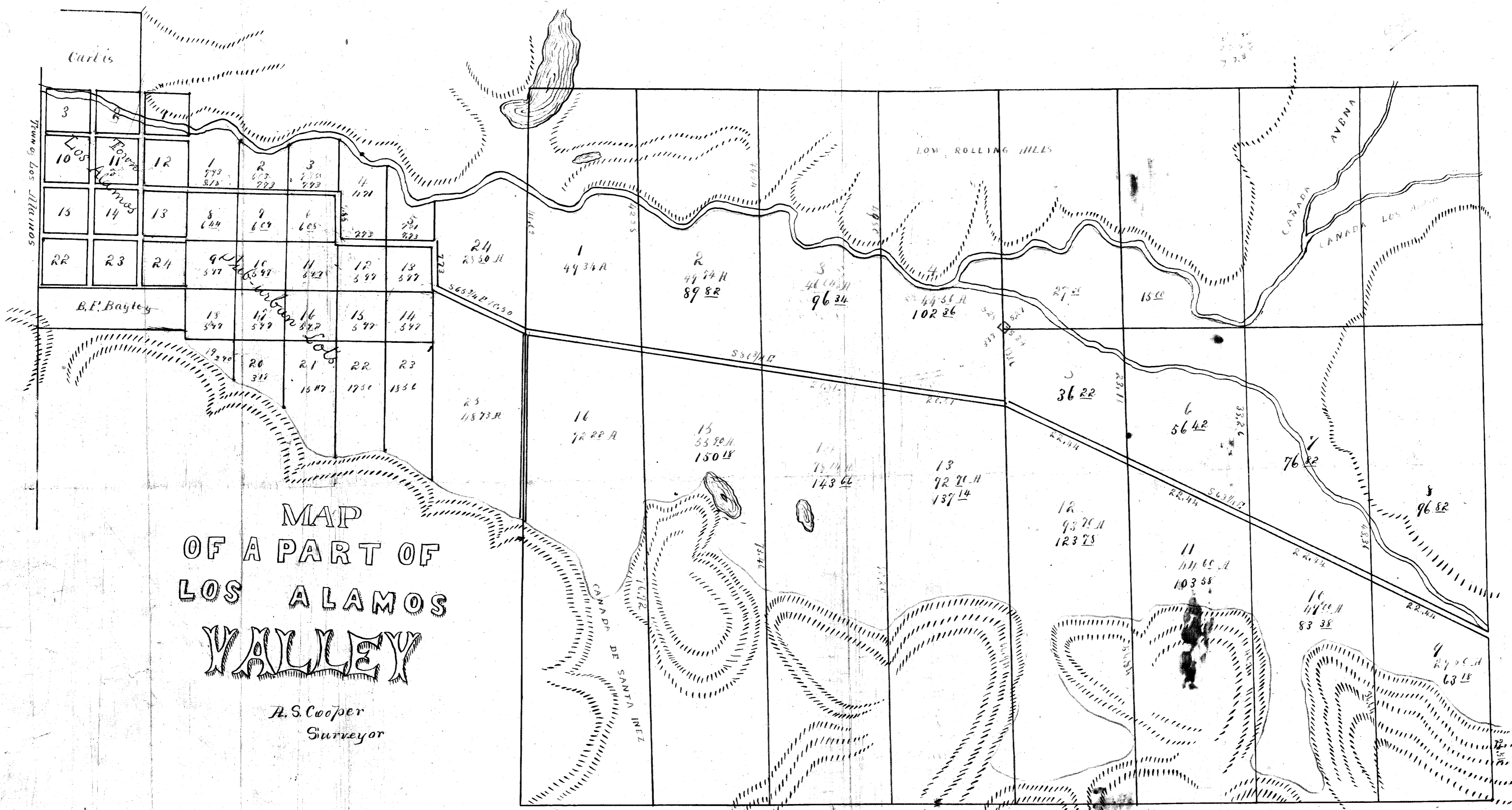

MAP
 OF A PART OF
 LOS ALAMOS
 VALLEY

A.S. Cooper
 Surveyor

Recorded at the request of J. B. Shaw, January Seventh A. D. 1881, at three o'clock P. M. in
 B. of Miscellaneous Records page 426.
 A. B. Williams, County Recorder, P. J. Janssen, Deputy.