

J.S. BELLE

TO GUADALUPE

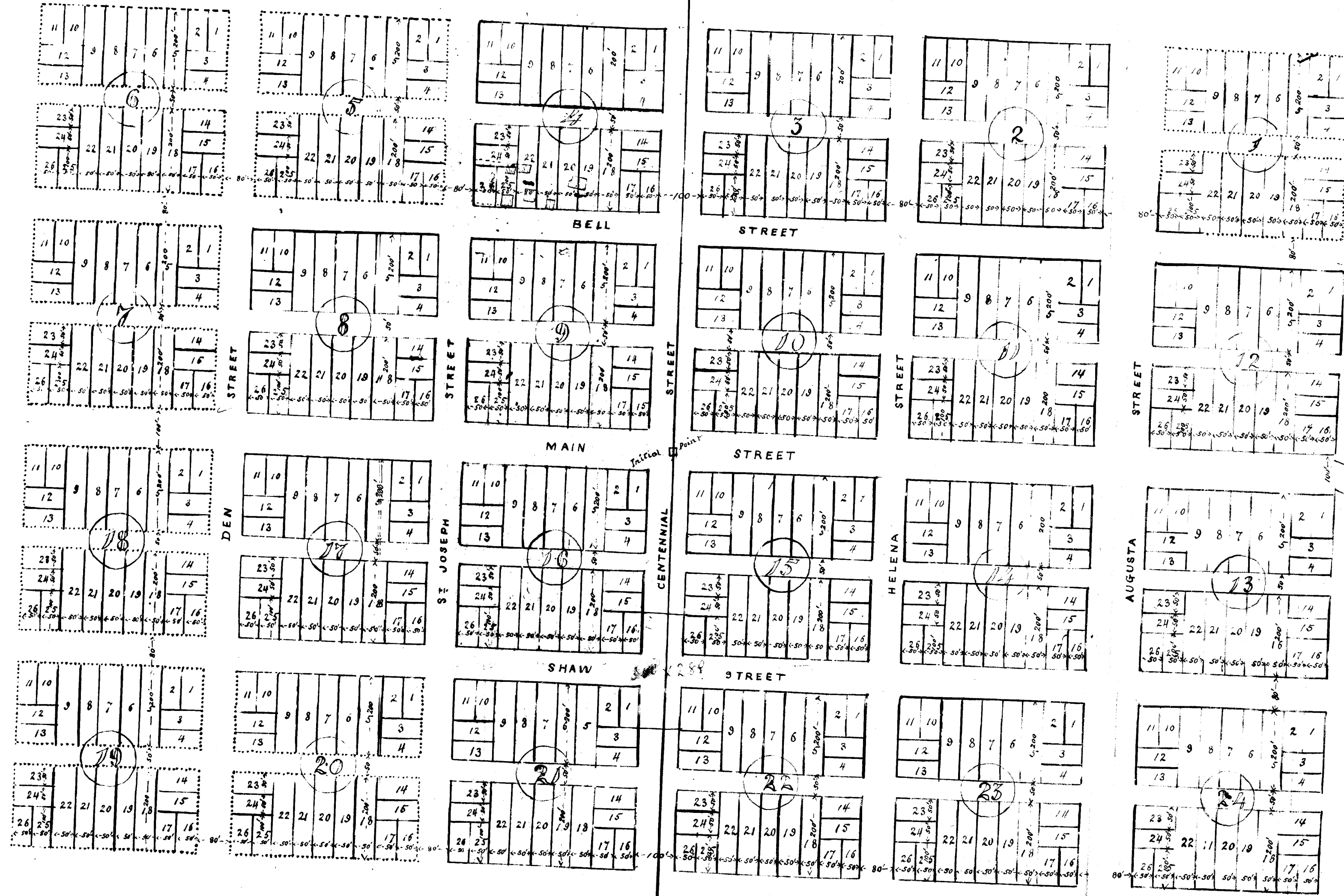

D. J. SHAW

TO SANTA BARBARA

MAP  
 OF  
 THE TOWN OF  
**Los Alamos**  
 SITUATED  
 IN THE COUNTY  
 OF  
**SANTA BARBARA,**  
 SURVEYED FOR  
 D. J. SHAW & J. S. BELLE.

September 15<sup>th</sup>  
 1876

Scale 200 ft. to one inch.

Recorded at request of P. N. Shaw, February  
 1<sup>st</sup> 1879 at the office of P. N.  
 J. B. Huntington, County Recorder  
 by J. S. Belle

406

M. L. T. B.  
 Page 406

OLD FILE PLAN  
 Misc  
 BOOK NO. 8  
 PAGE NO. 406