

SE 1/4 of SE 1/4 of Sec 10 N.R. 34 W.S.

SE 1/4 of SE 1/4 of Sec 10 T.10 N.R. 34 W.S.B.M.

S.W. 1/4 of S.W. 1/4 of Sec 11 T.10 N.R. 34 W.S.B.M.

*John A. Smith*

*John A. Smith*

*John A. Smith*



MAP of Smith & Co. Inc.

Let at request of Thornburg Get 29 1/2 1883 at 9 o'clock A.M.

W.W. Smith & Co. Sec 10 N.R. 34 W.S.B.M.

NEW NATIONAL SALES IN THE S.W. 1/4 W.S.B.M.

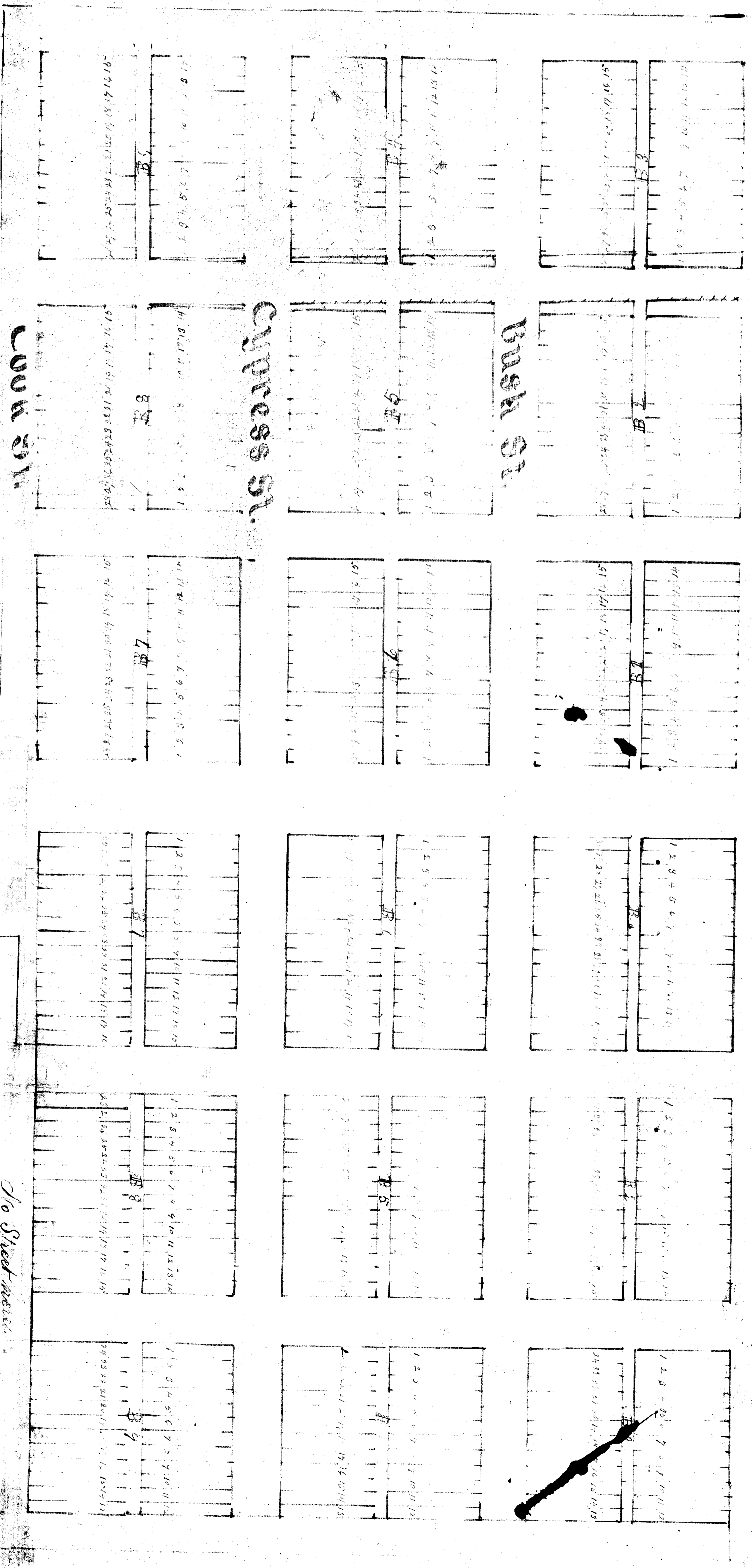
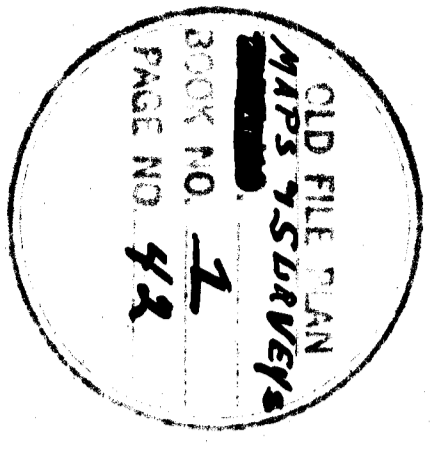

*Lang*

*Die Street*