

# TOWN OF CARPINTERIA

MAP OF THE

Surveyed by  
GEO. F. WRIGHT, C.E.

SANTA BARBARA  
California

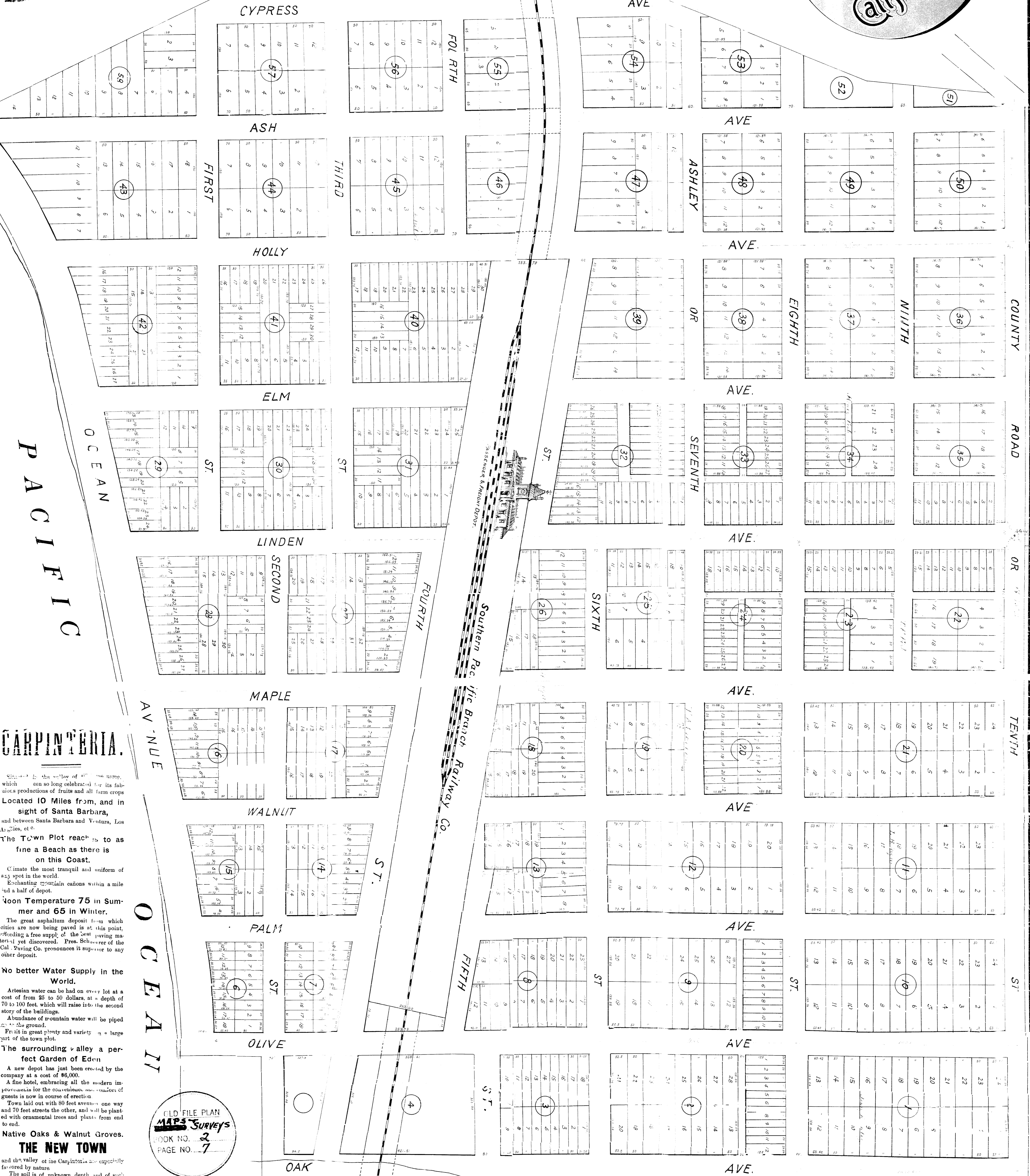
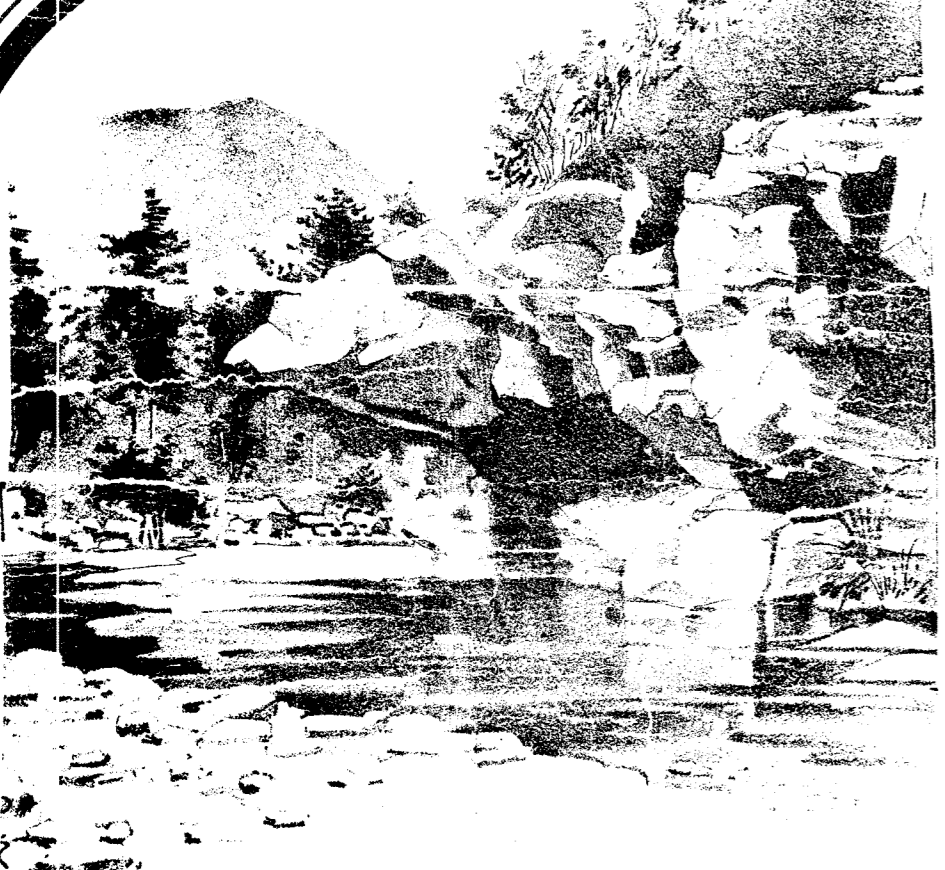

## CARPINTERIA.

Situated in the valley of the same name, which has long celebrated for its fabulous productions of fruits and all farm crops. Located 10 Miles from, and in sight of Santa Barbara, and between Santa Barbara and Ventura, Los Angeles, etc.

The Town Plot reaches to as fine a Beach as there is on this Coast.

Climate the most tranquil and uniform of any spot in the world.

Enchanting mountain cañons within a mile and a half of depot.

Noon Temperature 75 in Summer and 65 in Winter.

The great asphaltum deposit from which cities are now being paved is at this point, affording a free supply of the best paving material yet discovered. Free Schreiber of the Cal. Paving Co. pronounces it superior to any other deposit.

No better Water Supply in the World.

Artesian water can be had on every lot at a cost of from 25 to 50 dollars, at a depth of 70 to 100 feet, which will raise into the second story of the buildings.

Abundance of mountain water will be piped to the ground.

Fit in great plenty and variety in every part of the town plot.

The surrounding valley a perfect Garden of Eden.

A new depot has just been erected by the company at a cost of \$6,000.

A fine hotel, embracing all the modern improvements for the convenience and comfort of guests is now in course of erection.

Town laid out with 80 feet avenues one way and 70 feet streets the other, and will be planted with ornamental trees and plants from end to end.

Native Oaks & Walnut Groves.

**THE NEW TOWN**

and the valley of the Carpinteria are especially favored by nature.

The soil is of unknown depth and of such great fertility that plants, flowers, and fruits grow in perfect luxuriance.

The scenery of mountains, streams and islands is all that the lover of the grand in nature could desire. The main range extends in crescent form from north-west to south-east, projecting an unbroken barrier to the hot winds of the south and to the cold north winds.

The proximity to Santa Barbara, added to all the other attractions, will cause this to become one of the most prosperous residential towns in Southern California. Its natural advantages far surpass those of Pasadena.

The perfect beach, affording many miles of beautiful driving, the water, delightful for bathing, with no undertow, should gain for this the reputation of being the "Newport" of all persons seeking homes are requested to investigate these facts for themselves.

OLD FILE PLAN  
MAPS SURVEYS  
BOOK NO. 2  
PAGE NO. 7

Red broken lines show property lines as they existed in 1888.

The lands are laid out on the plan by the land in trust granted to the City of Santa Barbara by the City of Santa Barbara June 1, 1888, lying south of the Pacific Ocean Avenue.

Geo. F. Wright, Surveyor

Filed April 24, 1889.

