

RECORD OF SURVEY

VANDENBERG AIR FORCE BASE

GPS CONTROL SURVEY FOR THE ESTABLISHMENT OF THE SOUTH BASE BOUNDARY, ZERO DEVELOPMENT LINES AND LOW DEVELOPMENT LINE THROUGHOUT RANCHO LA ESPADA, BOOK 1, PAGE 9, M&S, RANCHO LOMPOC, BOOK 1, PAGE 45, M&S, RANCHO PUNTA DE LA CONCEPCION, BOOK 9, PAGES 1-8, M&S, RANCHO SAN JULIAN, BOOK 14, PAGES 7-12, M&S, RANCHO LA MISSION VIEJA DE LA PURISMA, BOOK 1, PAGE 45, M&S AND RANCHO NUESTRA SENORA DEL REFUGIO, BOOK "A", PAGE 17, PATENTS, ALL AS FILED IN THE OFFICE OF THE COUNTY RECORDER IN THE COUNTY OF SANTA BARBARA, STATE OF CALIFORNIA

JOHNSON-FRANK AND ASSOCIATES, INC.
DATE OF SURVEY: JUNE 1991 THROUGH JANUARY 1992 BOBBY G. JOHNSON P.L.S. 4140

SURVEYOR'S STATEMENT

THIS MAP CORRECTLY REPRESENTS A SURVEY MADE BY ME OR UNDER MY DIRECTION IN CONFORMANCE WITH THE REQUIREMENTS OF THE LAND SURVEYOR'S ACT AT THE REQUEST OF THE UNITED STATES ARMY CORPS OF ENGINEERS IN MAY 1991.

Bobby G. Johnson
BOBBY G. JOHNSON
P.L.S. 4140
LICENSE EXPIRATION DATE 6-30-96



COUNTY RECORDER'S STATEMENT

FILED THIS 13 DAY OF AUG, 1992 AT 3:50 PM IN BOOK 143 OF RECORDS OF SURVEYS AT PAGES 81-89, AT THE REQUEST OF THE UNITED STATES ARMY CORPS OF ENGINEERS.

FEE: \$22.00

KENNETH A. PETTIT
COUNTY CLERK RECORDER

BY: *Francis Mason*
DEPUTY

COUNTY SURVEYOR'S STATEMENT

THIS MAP HAS BEEN EXAMINED IN ACCORDANCE WITH SECTION 8766 OF THE LAND SURVEYORS ACT THIS 13th DAY OF August 1992.

FRANCIS G. SCOTT
COUNTY SURVEYOR

BY: *Francis Scott*
COUNTY SURVEYOR

R.C.E. NO. 18222
REGISTRATION EXPIRATION DATE: 6/30/93

STATEMENT OF PURPOSE

THE PURPOSE OF THIS SURVEY IS TO DENSIFY THE EXISTING 1983 NORTH AMERICAN DATUM NATIONAL GEODETIC SURVEY CONTROL NETWORK TO FACILITATE THE ESTABLISHMENT OF ZERO AND LOW DEVELOPMENT RESTRICTION LINES.

NOTE

ALL GPS SURVEY DATA WAS ADJUSTED USING GEOLAB, VERSION 1.915.

POSITIONS FOR ALL POINTS SHOWN HEREON MEET THE SPECIFICATIONS FOR FIRST ORDER ACCURACY AS STATED IN THE FEDERAL GEODETIC CONTROL COMMITTEE'S PROPOSED GUIDELINE PUBLISHED AS GEOMETRIC GEODETIC ACCURACY STANDARDS AND SPECIFICATIONS FOR USING G.P.S. RELATIVE POSITIONING TECHNIQUES VERSION 5.0 DATED MAY 11, 1988, REPRINTED WITH CORRECTIONS: AUGUST 1, 1989.

GPS REPORT IS AVAILABLE IN THE OFFICE OF JOHNSON-FRANK AND ASSOC., INC.

TOPOGRAPHIC NOTE:

THE FOLLOWING UNITED STATES GEOLOGICAL SURVEY QUADRANGLES (7.5 MINUTE SERIES) WERE USED FOR THE TOPO OVERLAY SHOWN ON SHEETS 2-6:

POINT CONCEPTION - PHOTOINSPECTED 1974
LOMPOC HILLS - PHOTOINSPECTED 1971
TRANQUILLON MTN. - PHOTOINSPECTED 1978
SURF - PHOTOREVISED 1974

THE TOPO OVERLAY HAS BEEN SHOWN FOR CONVENIENCE AND VICINITY PURPOSES ONLY. ANY LINES OR SYMBOLS ON SAID TOPO SHOWING RANCHO LINES, SECTION LINES OR OTHER BOUNDARY LINES ARE GRAPHIC REPRESENTATION ONLY.

STATEMENT OF AUTHORITY

PURSUANT TO THE AUTHORITY PROVIDED BY 10 UNITED STATES CODE 2663, THE SECRETARY OF THE AIR FORCE MAY ACQUIRE THE RESTRICTIVE EASEMENT IDENTIFIED IN THE ATTACHED SURVEY.

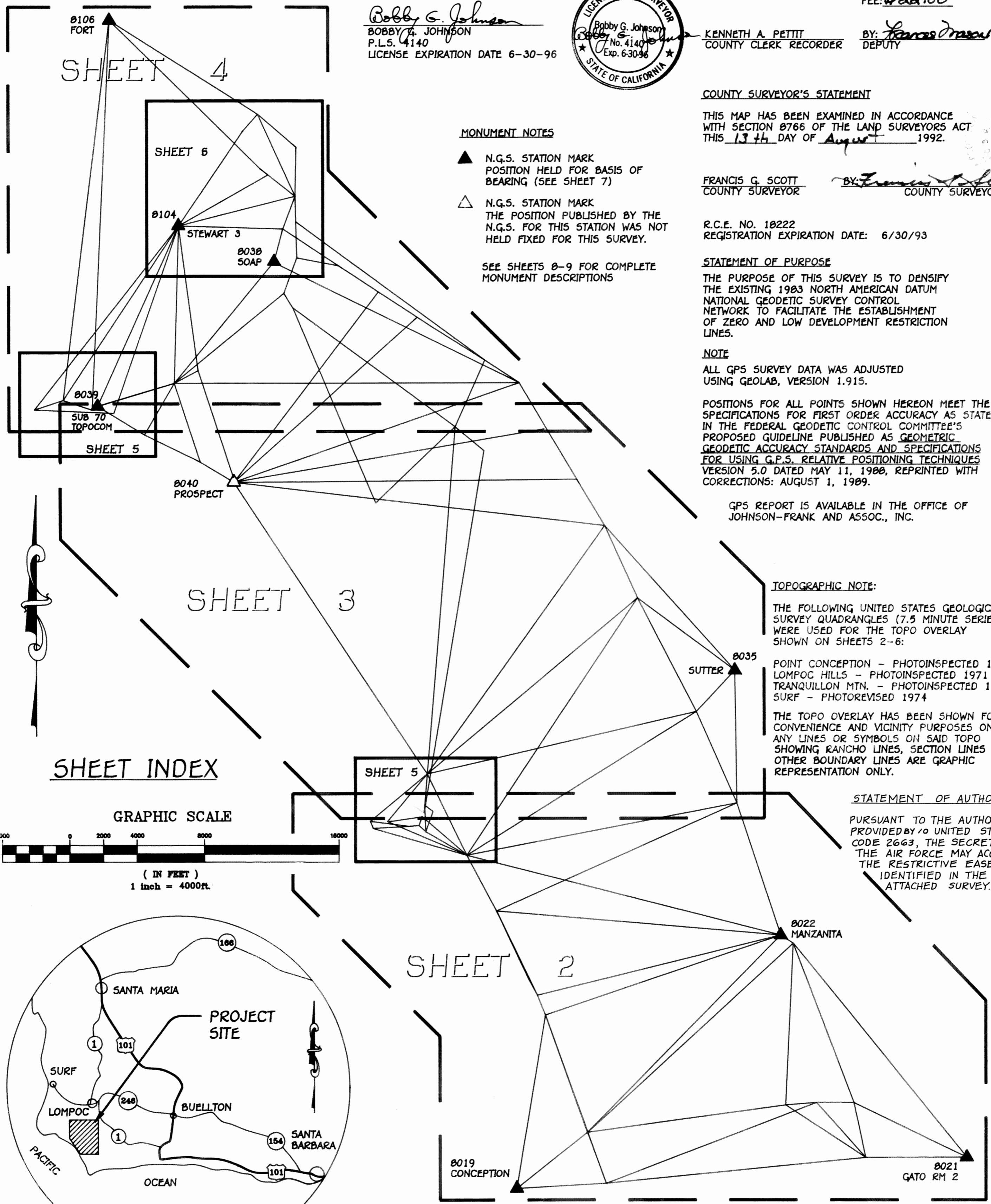

MONUMENT NOTES

- ▲ N.G.S. STATION MARK POSITION HELD FOR BASIS OF BEARING (SEE SHEET 7)
- △ N.G.S. STATION MARK THE POSITION PUBLISHED BY THE N.G.S. FOR THIS STATION WAS NOT HELD FIXED FOR THIS SURVEY.

SEE SHEETS 8-9 FOR COMPLETE MONUMENT DESCRIPTIONS

SHEET 4

SHEET 6

SHEET 5

SHEET 3

SHEET 5

SHEET 2

SHEET INDEX

GRAPHIC SCALE

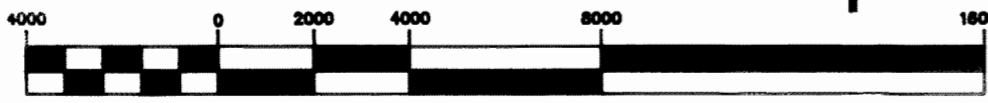

(IN FEET)
1 inch = 4000ft.

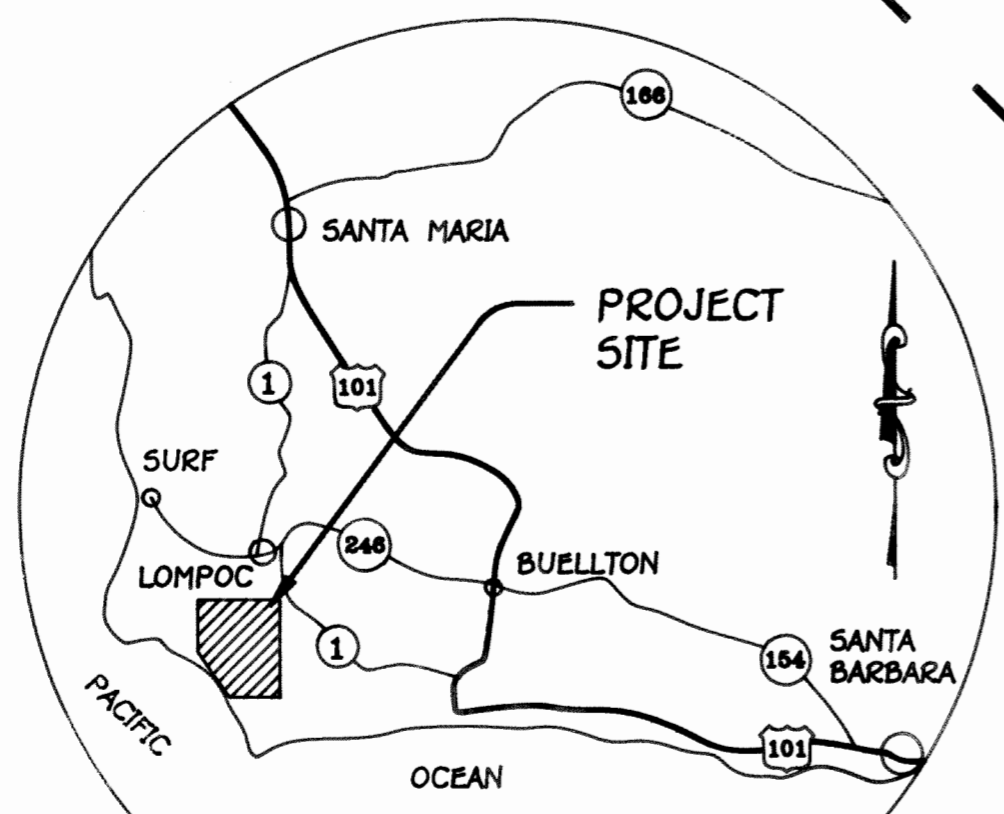

VICINITY MAP
NO SCALE