

LEGEND:

- SET 1/2" IRON PIPE WITH PLUG MARKED "LS 5470"
- SET 2" IRON PIPE IN CONCRETE FLUSH WITH THE GROUND SURFACE WITH A 2 1/2" DIA BRASS CAP MARKED "CMA CONTROL POINT PLS 5470" AND STAMPED WITH THE NUMBER DESIGNATION AS NOTED HEREON
- SET MONUMENT AS NOTED IN STATION DESCRIPTIONS
- △ FOUND MONUMENT AS NOTED IN STATION DESCRIPTIONS

- CODE THAT IDENTIFIES A CONTROL POINT IN THE NATIONAL GEODETIC REFERENCE SYSTEM.
- DMS DEGREES MINUTES SECONDS
- M INTERNATIONAL METERS
- USF UNITED STATES SURVEY FEET

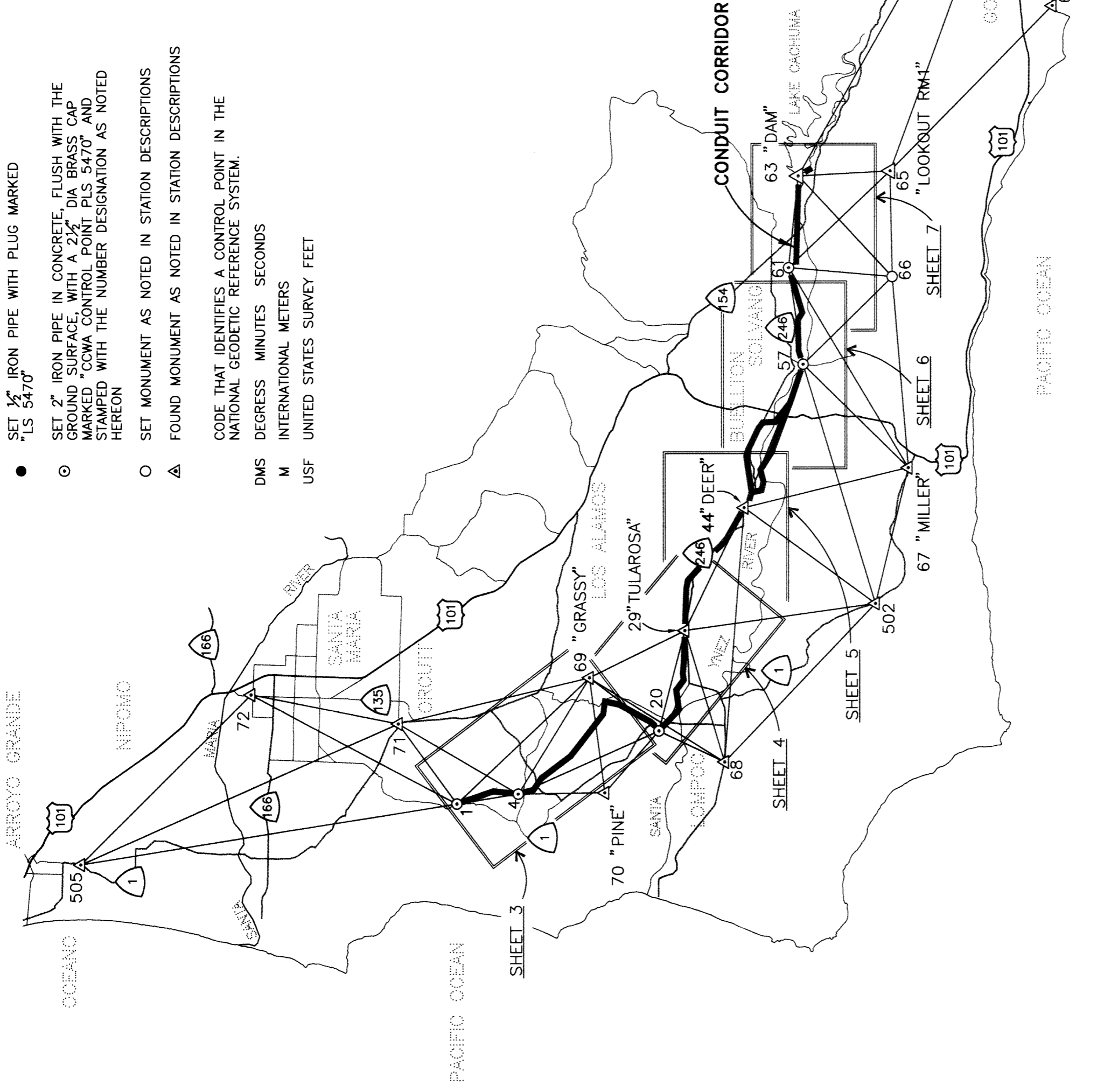

RECORDER'S STATEMENT

FEE \$20.00
 FILED THIS 16th DAY OF August, 1995.
 RECORD OF SURVEYS AT PAGE(S) 17-23
 AT THE REQUEST OF PENFIELD & SMITH - ENGINEERS * SURVEYORS
 KENNETH A. PETTI COUNTY CLERK-RECORDER-ASSESSOR
 SANTA BARBARA COUNTY
 BY: *Marvin Butke* DEPUTY COUNTY RECORDER

10433RS1.DWG
 07/11/95

COUNTY SURVEYOR'S STATEMENT

THIS MAP HAS BEEN EXAMINED IN ACCORDANCE WITH SECTION 8766 OF THE LAND SURVEYOR'S ACT.
 THIS IS the DAY OF August, 1995.
 BY: *Edmund R. Villa* COUNTY SURVEYOR
 P.L.S. NO.: 6232 LICENSE EXPIRATION DATE: 3-31-98

SURVEYOR'S STATEMENT

THIS MAP CORRECTLY REPRESENTS A SURVEY MADE BY ME OR UNDER MY DIRECTION IN CONFORMANCE WITH THE REQUIREMENTS OF THE LAND SURVEYOR'S ACT AT THE REQUEST OF THE CENTRAL COAST WATER AUTHORITY
 IN AUGUST, 1992
 P.L.S. NO.: 5470 LICENSE EXPIRATION DATE: 8-31-98

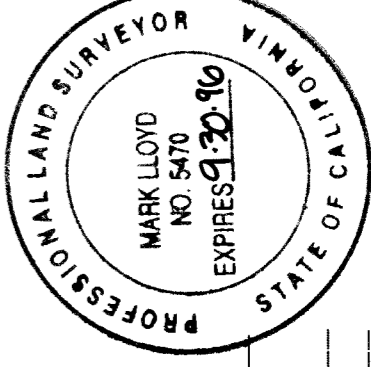

STATION DESCRIPTIONS

- STATIONS LYING OUTSIDE THE CONDUIT CORRIDOR ARE DESCRIBED HERE. STATIONS ALONG THE CONDUIT CORRIDOR ARE DESCRIBED ON SHEETS 3 - 7.
- 64 FOUND CALIFORNIA STATE LANDS COMMISSION BRASS CAP MONUMENT STAMPED "PARK 1957" SET FLUSH IN SANDSTONE ROCK AT TOP OF BLUFF AT THE WESTERLY END OF THE GOLETA BEACH PARKING LOT PER 41 RS 68.
 - 65 FOUND US&GS BRASS DISK STAMPED "SANTA YNEZ 1941 NO. 1" AT THE SUMMIT OF SANTA YNEZ PEAK SET FLUSH IN CONCRETE PLATFORM AT THE BASE OF THE STEPS THAT LEAD UP TO THE OLD LOOKOUT TOWER. STATION SANTA YNEZ, SANTA YNEZ NO. 2 AND THE LOOKOUT TOWER HAVE ALL BEEN REMOVED OR DESTROYED.
 - 66 SET PK NAIL AND TAG MARKED "LS 5470" IN SANDSTONE BOULDER APPROX 20 FEET UP NORTHERLY SIDE SLOPE OF REFUGIO ROAD. THE STATION IS APPROX 6.05 MILES FROM THE INTERSECTION OF REFUGIO ROAD AND HIGHWAY 101, AT THE BEGINNING OF A CURVE IN REFUGIO ROAD WITH A 150 DEGREE DELTA CURVE TO THE LEFT.
 - 67 FOUND DEPARTMENT OF TRANSPORTATION BRASS CAP MONUMENT STAMPED "MILLER 1974" AT THE TOP OF CUT SLOPE SOUTHERLY OF THE HIGHWAY 1 SOUTHBOUND TO HIGHWAY 101 SOUTHBOUND TRANSITION RAMP.
 - 68 FOUND 2 INCH IRON PIPE WITH TAG MARKED "LS 4597" IN A STANDARD MONUMENT WELL AT THE INTERSECTION OF AVALON STREET AND OLIVE AVENUE IN THE CITY OF LOMPOC PER 142 RS 82.
 - 70 FOUND US&GS BRASS DISK SET FLUSH IN CONCRETE POST 8" ABOVE GROUND, STAMPED "PINE 1961" PER 142 RS 82. THE STATION IS WITHIN THE BOUNDARY OF VAFB.
 - 71 FOUND 9/16 INCH DIAMETER STAINLESS STEEL ROD, DRIVEN VERTICALLY INTO GROUND, WITH A 2-1/2" DIAMETER BRASS CAP STAMPED "S.B.Co. GPS CONTROL 1992 PLS 5470 STA 1009" AND CENTER PUNCHED. THE STATION IS INSIDE A 6 INCH DIAMETER ALUMINUM MONUMENT WELL FLUSH WITH THE SURFACE AND IS LOCATED AT THE INTERSECTION OF CLARK AVE. AND HIGHWAY 1 IN ORCUT DESIGNATED STATION 1009 ON THE RECORD OF SURVEY MAP OF THE GPS CONTROL SURVEY FOR THE SANTA MARIA VALLEY TOPOGRAPHIC MAPPING PROJECT SUBMITTED BY THIS FIRM TO THE COUNTY SURVEYOR'S OFFICE UNDER FILE NO. 5864, WHICH WILL NOT RECORD BEFORE THIS MAP.
 - 72 FOUND 9/16 INCH DIAMETER STAINLESS STEEL ROD, DRIVEN VERTICALLY INTO GROUND, WITH A 2-1/2" DIAMETER BRASS CAP STAMPED "S.B.Co. GPS CONTROL 1992 PLS 5470 STA 1006" AND CENTER PUNCHED. THE STATION IS INSIDE A 6 INCH DIAMETER ALUMINUM MONUMENT WELL FLUSH WITH THE SURFACE AND IS LOCATED AT THE INTERSECTION OF DONOVAN ROAD AND BROADWAY IN SANTA MARIA. DESIGNATED STATION 1006 ON THE RECORD OF SURVEY MAP OF THE GPS CONTROL SURVEY FOR THE SANTA MARIA VALLEY TOPOGRAPHIC MAPPING PROJECT SUBMITTED BY THIS FIRM TO THE COUNTY SURVEYOR'S OFFICE UNDER FILE NO. 5864, WHICH WILL NOT RECORD BEFORE THIS MAP.
 - 501 FOUND 9/16 INCH DIAMETER STAINLESS STEEL ROD, DRIVEN VERTICALLY INTO GROUND, WITH A 2-1/2" DIAMETER ALUMINUM CAP STAMPED "CALIF DEPT OF TRANSPORTATION HPGN-CALIF STA 05-01" AND CENTER PUNCHED. THE STATION IS LOCATED ON THE SOUTHERLY SIDE OF US HIGHWAY 101, AT THE TOP OF ORTEGA RIDGE NEAR THE RIGHT OF WAY FENCE IN A LARGE TURNOUT AREA, AND HAS A FIBERGLASS WITNESS POST.
 - 502 FOUND 9/16 INCH DIAMETER STAINLESS STEEL ROD, DRIVEN VERTICALLY INTO GROUND, WITH A 2-1/2" DIAMETER ALUMINUM CAP STAMPED "CALIF DEPT OF TRANSPORTATION HPGN-CALIF STA 05-02" AND CENTER PUNCHED. THE STATION IS LOCATED ON THE WESTERLY SIDE OF HIGHWAY 1, APPROX 2.5 FEET FROM THE RIGHT OF WAY FENCE, AT POST MILE 7.61, AND HAS A FIBERGLASS WITNESS POST.
 - 505 FOUND 9/16 INCH DIAMETER STAINLESS STEEL ROD, DRIVEN VERTICALLY INTO GROUND, WITH A 2-1/2" DIAMETER ALUMINUM CAP STAMPED "CALIF DEPT OF TRANSPORTATION HPGN-CALIF STA 05-05" AND CENTER PUNCHED. THE STATION IS LOCATED ON THE WESTERLY SIDE OF HIGHWAY 1, APPROX 2.5 FEET FROM THE RIGHT OF WAY FENCE, AND HAS A FIBERGLASS WITNESS POST. THE STATION IS 1.05 MILES SOUTHERLY FROM THE INTERSECTION OF HIGHWAY 1 AND VALLEY ROAD.

RECORD OF SURVEY

OF A CONTROL NETWORK ESTABLISHED FOR THE CENTRAL COAST CONDUIT PROJECT IN THE COUNTY OF SAN LUIS OBISPO AND THE COUNTY OF SANTA BARBARA
 SANTA BARBARA COUNTY STATE OF CALIFORNIA
 SCALE: 1" = 5 MILES
 AUGUST, 1992
Penfield & Smith
 ENGINEERS * SURVEYORS
 111 E. VICTORIA ST. SANTA BARBARA (805) 963-9532 CALIF. 93101 MAILING ADDRESS: P.O. BOX 98 (93102)
 SHEET 1 OF 7 SHEETS W.O. 10433.01