

LEGEND

- ▲ FOUND 9/16 INCH DIAMETER ALUMINUM ALLOY ROD, DRIVEN TO REFUSAL, WITH A 2-1/2 INCH DIAMETER ALUMINUM CAP STAMPED "CALIF. DEPT. OF TRANSPORTATION HPGN-CALIF" AND WITH HPGN STATION NUMBER AS DESIGNATED HEREON. THE MONUMENT IS INSIDE A 6-INCH DIAMETER ALUMINUM MONUMENT WELL FLUSH WITH THE GROUND SURFACE.
- ⊙ SET 2 INCH DIAMETER IRON PIPE WITH A 2 1/4 INCH DIAMETER BRASS CAP STAMPED "SANTA BARBARA CONTROL NETWORK STATION 1995 PLS 6167" AND WITH MONUMENT NUMBER AS DESIGNATED HEREON. THE MONUMENT IS INSIDE A 12 INCH DIAMETER CAST IRON MONUMENT WELL FLUSH WITH THE GROUND SURFACE. SEE STATION DESCRIPTIONS FOR EXACT LOCATION OF MONUMENT.
- FOUND OR SET MONUMENT AS NOTED IN STATION DESCRIPTIONS
- FOUND MONUMENT AS NOTED IN BENCHMARK DESCRIPTIONS
- 0001 CITY OF SANTA BARBARA PUBLIC WORKS MONUMENT NUMBER DESIGNATION
- PID PERMANENT IDENTIFIER: THE UNIQUE SIX-CHARACTER CODE THAT IDENTIFIES A CONTROL POINT IN THE NATIONAL GEODETIC REFERENCE SYSTEM.
- (USF) UNITED STATES SURVEY FEET
- (M) INTERNATIONAL METERS
- (DMS) DEGREE MINUTES SECONDS

STATEMENT OF PURPOSE

THE MONUMENTS SHOWN ON THIS SURVEY, FOUND AND SET, ARE A HORIZONTAL AND VERTICAL CONTROL NETWORK ESTABLISHED IN THE CITY OF SANTA BARBARA AS A BASIS FOR TOPOGRAPHIC MAPPING AND AS THE SANTA BARBARA CONTROL NETWORK.

NOTES

1. THE SURVEY WAS PERFORMED IN MAY, 1995 USING THREE ASHTECH LD-12 DUAL-FREQUENCY GPS RECEIVERS AND ONE ASHTECH M-12 SINGLE FREQUENCY GPS RECEIVER OPERATING IN STATIC MODE WITH AN AVERAGE 90-MINUTE OCCUPATION TIME. BASELINE PROCESSING WAS DONE WITH "ASHTech GPPS" SOFTWARE VERSION 5.0. USING THE SINGLE FREQUENCY OBSERVABLES AND THE BROADCAST EPHEMERIS, THE VERTICAL CONTROL WAS PERFORMED USING A WILD NA-2000 ELECTRONIC LEVEL WITH SECTIONED FIBERGLASS RODS. NETWORK ADJUSTMENT WAS PERFORMED WITH STAR*NET VERSION 5.04.
2. THE HORIZONTAL DATUM OF THE NETWORK IS NAD 83 (1992), AND NEW NETWORK STATION POSITIONS HAVE BEEN DERIVED FROM TIES TO THREE ORDER "B" STATIONS OF THE CALIFORNIA HIGH PRECISION GEODETIC NETWORK (HPGN): "HPGN CA 05-01" (PID EW9544), "HPGN CA 05-02" (PID DZ1796) AND "HPGN CA 05-04" (PID FU3789).

THE BEARINGS SHOWN HEREON ARE REFERENCED TO CCS83, ZONE 5 GRID NORTH. THE POSITIONS OF THE THREE HPGN POINTS NOTED ABOVE HAVE BEEN USED AS THE BASIS OF BEARINGS FOR THIS MAP.

THIS SURVEY WAS NOT PERFORMED ACCORDING TO THE "GEOMETRIC GEODETIC ACCURACY STANDARDS AND SPECIFICATIONS FOR USING GPS RELATIVE POSITIONING TECHNIQUES", FEDERAL GEODETIC CONTROL COMMITTEE, AUGUST 1989; HOWEVER, FOR NEW STATION POSITIONS ESTABLISHED BY GPS IN THIS NETWORK, THE RELATIVE HORIZONTAL ACCURACIES ACHIEVED IN THIS SURVEY, AS LISTED ON SHEET 3 (e.g. "FIRST ORDER", etc.) MEET OR EXCEED THE EQUIVALENT GUIDELINE ACCURACIES FOR GPS SURVEYS AS OUTLINED IN SAID STANDARDS AND SPECIFICATIONS.

3. THE VERTICAL DATUM OF THE NETWORK IS NAVD 88, AND NETWORK STATION ELEVATIONS HAVE BEEN DERIVED FROM DIFFERENTIAL LEVELING TIES TO ELEVEN (11) FIRST-ORDER BENCHMARKS OF THE NATIONAL GEODETIC REFERENCE SYSTEM: "A 609" (PID EW3756), "C 658" (PID EW3758), "H 1215" (PID EW3761), "K 1215" (PID EW3749), "R 28" (PID EW3739), "S 1441" (PID EW9489), "T 1441" (PID EW9490), "T 28" (PID EW3735), "W 1042" (PID EW3766), "941 1340 TIDAL 1" (PID EW3742), "941 1340 TIDAL 2" (PID EW3741).

ANALYSIS OF LOOP CLOSURES INDICATES VERTICAL ACCURACIES COMPARABLE TO SECOND ORDER, CLASS 2 ACCURACY STANDARDS AS OUTLINED IN "STANDARDS AND SPECIFICATIONS FOR GEODETIC CONTROL NETWORKS", FEDERAL GEODETIC CONTROL COMMITTEE, SEPTEMBER 1984.

4. ELEVATIONS OF STATIONS 0001, 0002, 0003, 0005, 0006, 0007, 0021, 0025, 0027, 0028, 0035 AND 0036 ARE DERIVED FROM DIFFERENTIAL LEVELING. ELEVATIONS OF ALL OTHER STATIONS WERE ESTIMATED BY FIXING THE DIFFERENTIAL LEVELING DERIVED ELEVATIONS OF STATIONS 0001, 0002, 0005, 0006, 0007, 0021, 0025, 0027, 0028, 0035 AND 0036 IN THE NETWORK ADJUSTMENT, AND USING THE GEOID93 GEOID MODEL TO DERIVE THE GEOID/ELLIPSOID SEPARATION.

STREETS SHOWN HEREON ARE FOR INFORMATIONAL PURPOSES ONLY. MONUMENTS SET WERE NOT INTENDED TO BE ON STREET CENTERLINES. THE POSITIONS OF FOUND AND SET MONUMENTS RELATIVE TO STREET CENTERLINES HAVE NOT BEEN SURVEYED.

5. THE MONUMENT NUMBERS SHOWN HEREON WERE ASSIGNED BY THE CITY OF SANTA BARBARA PUBLIC WORKS DEPARTMENT.

6. A STATION RECOVERY SHEET FOR STATIONS 0001 THROUGH 0036 IS ON FILE AT THE CITY OF SANTA BARBARA PUBLIC WORKS DEPARTMENT OFFICE. THE STATION RECOVERY SHEET INCLUDES THE POSITION, ELEVATION, AND DESCRIPTION FOR THE SUBJECT STATION.

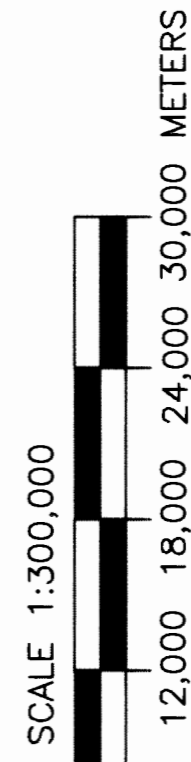
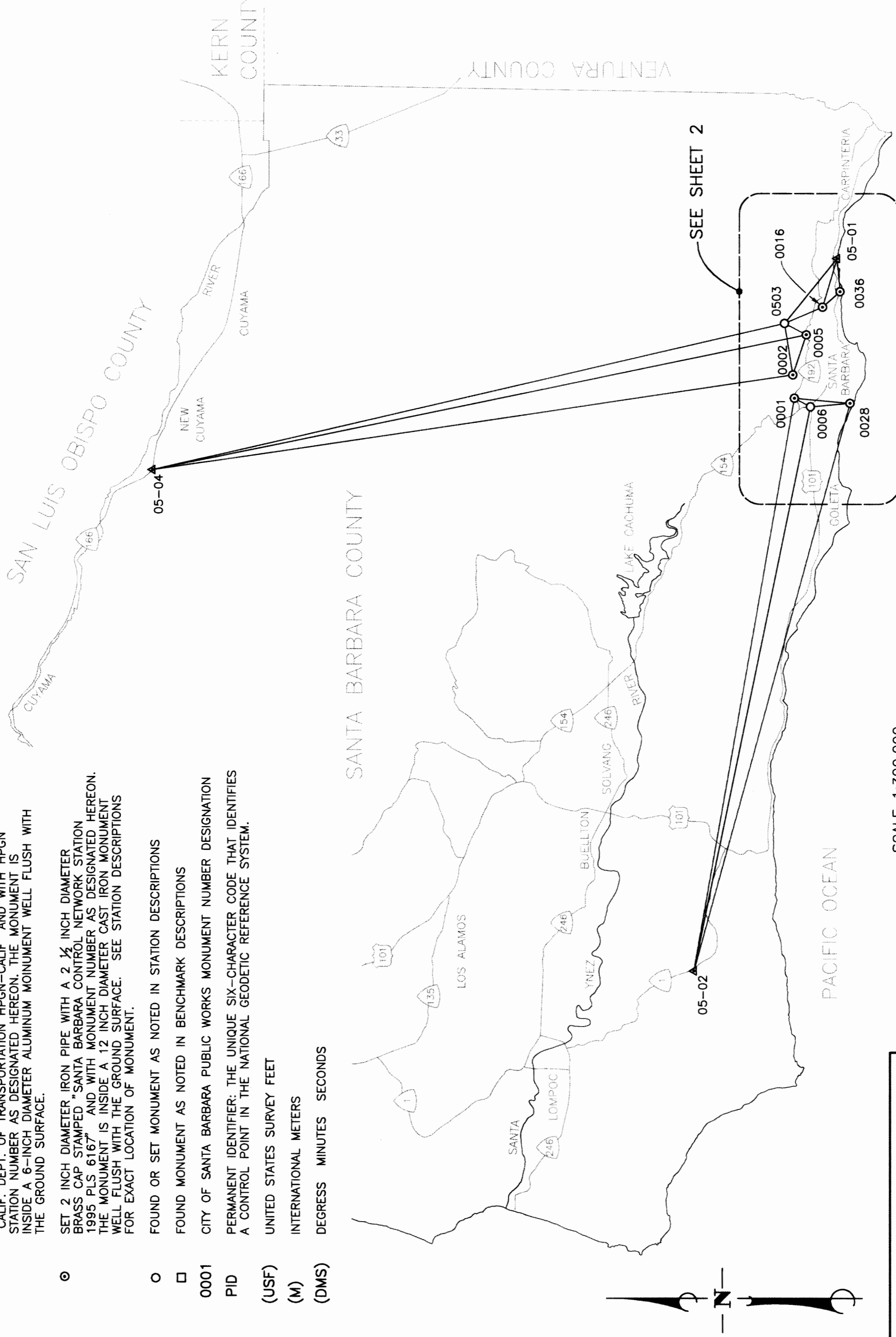

RECORDER'S STATEMENT

FILED THIS 6th DAY OF MARCH, 1996.
 AT 3:09 P.M. IN BOOK 147 OF 70-74
 RECORD OF SURVEYS AT PAGE 70-74
 AT THE REQUEST OF
 PENFIELD & SMITH - ENGINEERS * SURVEYORS
 KENNETH A. PETTIT
 COUNTY CLERK-RECORDER-ASSESSOR
 SANTA BARBARA COUNTY
 BY: Anna Buttk DEPUTY COUNTY RECORDER

COUNTY SURVEYOR'S STATEMENT

THIS MAP HAS BEEN EXAMINED IN ACCORDANCE WITH SECTION 8766 OF THE LAND SURVEYOR'S ACT
 THIS 5th DAY OF MARCH, 1996.
 BY: Edmund R. Villa COUNTY SURVEYOR
 P.L.S. NO.: 6232 LICENSE EXPIRATION DATE: 3-31-98

SURVEYOR'S STATEMENT

THIS MAP CORRECTLY REPRESENTS A SURVEY MADE BY ME OR UNDER MY DIRECTION IN CONFORMANCE WITH THE REQUIREMENTS OF THE LAND SURVEYOR'S ACT AT THE REQUEST OF THE CITY OF SANTA BARBARA
 IN MAY, 1995
 P.L.S. NO.: 6167 LICENSE EXPIRATION DATE: 3-31-98

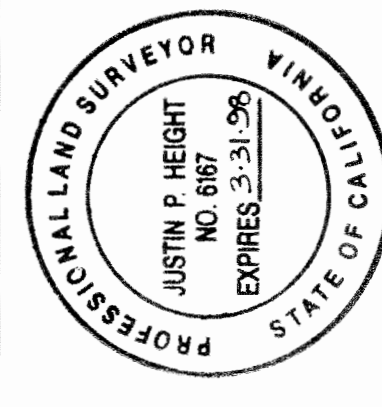

RECORD OF SURVEY

OF A CONTROL NETWORK ESTABLISHED FOR THE CITY OF SANTA BARBARA TOPOGRAPHIC MAPPING AND PERMANENT CONTROL PROJECT KNOWN AS THE SANTA BARBARA CONTROL NETWORK
 SANTA BARBARA COUNTY STATE OF CALIFORNIA
 SCALE: 1:300,000 MAY, 1995
Penfield & Smith
 ENGINEERS * SURVEYORS
 111 E. VICTORIA ST. SANTA BARBARA (805) 963-9532 CALIF. 93101 MAILING ADDRESS: P.O. BOX 98 (93102)
 SHEET 1 OF 5 SHEETS W.O. 11120.03