

# RECORD OF SURVEY

## BASIS OF BEARINGS

THE CALCULATED BEARING OF N 46°33'20" W BETWEEN FOUND MONUMENTS 0505 AND ALVIN 1974, PER NATIONAL GEODETIC SURVEY IS THE BASIS OF BEARINGS FOR THIS MAP.

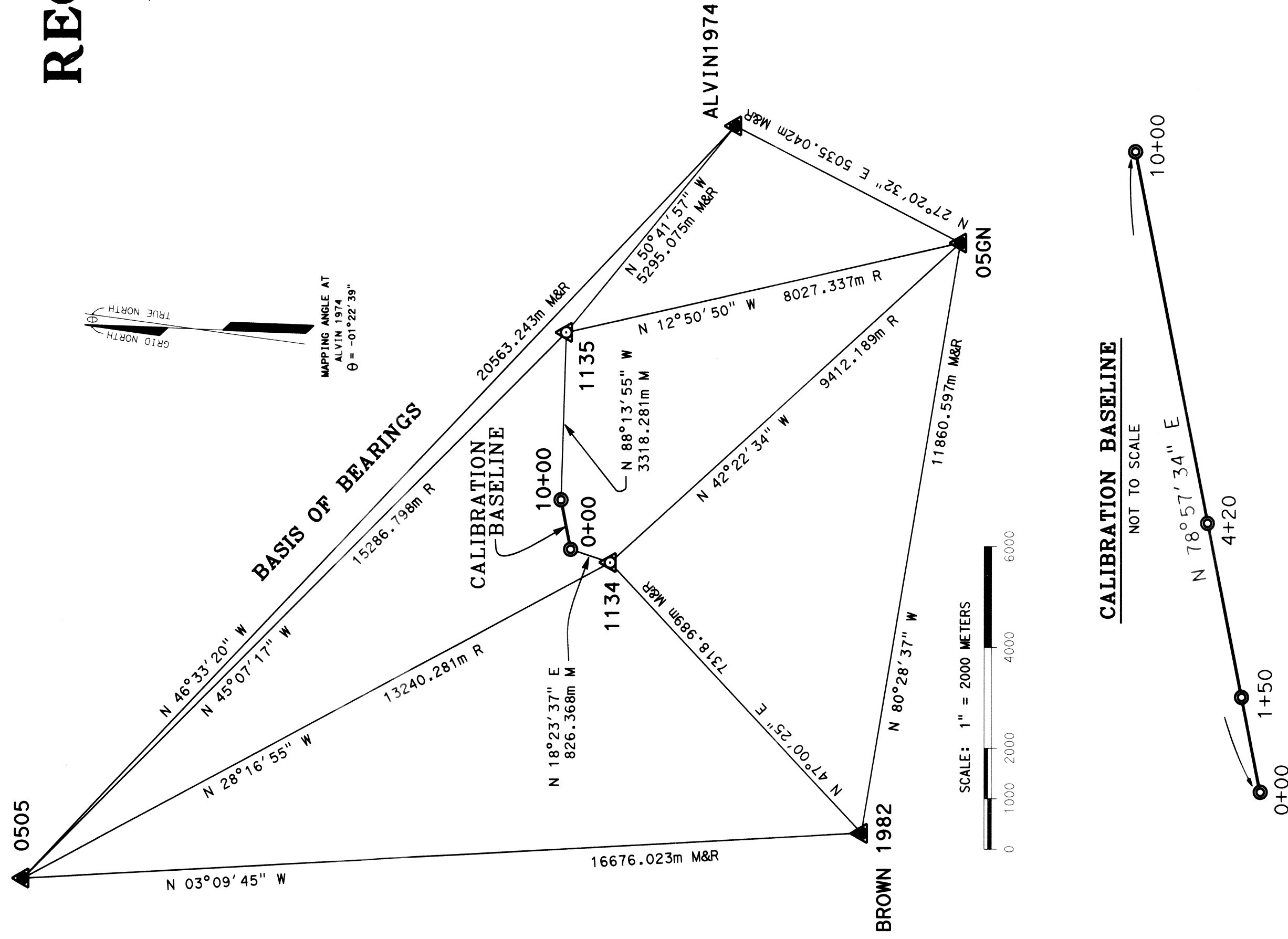
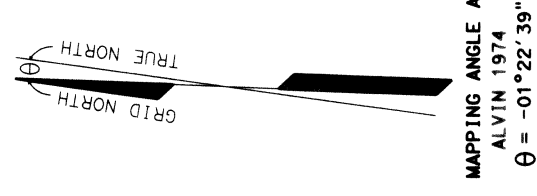

## CALIBRATION BASELINE

NOT TO SCALE

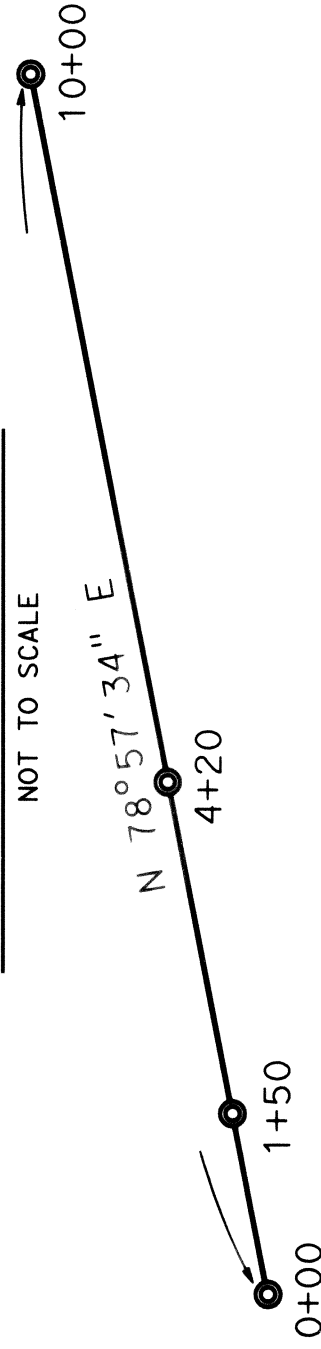

STATION	GROUND DISTANCE (METERS)	GROUND DISTANCE (FEET)
0+00 TO 1+50	149.9986	492.1204
0+00 TO 4+20	419.9992	1377.9474
0+00 TO 10+00	1000.0038	3280.8458
1+50 TO 4+20	270.0005	885.8266
1+50 TO 10+00	850.0052	2788.7254
4+20 TO 10+00	580.0046	1902.8984

NOTE: MEASURED DISTANCES ARE BASED ON FIELD OBSERVATIONS. BEARING OBSERVATIONS WERE MADE USING A NATIONAL GEODETIC SURVEY SYSTEM. ALL DISTANCES ARE MEASURED PER NOAA TECHNICAL MEMORANDUM NOS. NGS 8 WERE USED. TABLE DISTANCES SHOWN ARE GROUND NOT GRID.

- 0505  
N. 678761.431 (N. 678762.022)  
E. 1764375.227 (E. 1764374.739)  
2-1/2" ALUMINUM DISK IN 6" PVC WELL MONUMENT DISK STAMPED "HPGN-CALIF STA 05-05 1990"
- ALVIN 1974  
N. 664621.090 (N. 664621.673)  
E. 179304.987 (E. 179304.474)  
3-5/8" CALIFORNIA DIVISION OF HIGHWAYS BRASS DISK IN CONCRETE STAMPED "ALVIN 1974"
- BROWN 1982  
N. 662110.805 (N. 662111.403)  
E. 1765295.228 (E. 1765294.721)  
3-5/8" CALIFORNIA DIVISION OF HIGHWAYS BRASS DISK IN CONCRETE STAMPED "BROWN 1982"
- 05-GN  
N. 660148.562 (N. 660149.149)  
E. 1776992.381 (E. 1776991.866)  
CALIFORNIA DEPT. OF TRANSPORTATION 2-1/2" ALUMINUM DISK STAMPED "CA-HPGN DENSIFICATION STA 05-GN SB 101 PM 86.59 1993"
- 1134  
N. 667101.685 (N. 667102.291)  
E. 1770849.812 (E. 1770646.120)  
CORPS OF ENGINEERS-U.S. ARMY SURVEY MARK 3-1/2" BRASS DISK IN CONCRETE STAMPED 25M-109 1971 LA DIST

- 1135  
N. 667974.949 (N. 667975.550)  
E. 1775207.493 (E. 1775206.989)  
CORPS OF ENGINEERS-U.S. ARMY SURVEY MARK 3-1/2" NATIONAL GEODETIC SURVEY BRASS DISK IN CONCRETE STAMPED 25M-107 1971 LA DIST
- 0+00  
N. 667885.833 (N. 667886.427)  
E. 1770909.366 (E. 1770908.864)  
SET 3-1/2" NATIONAL GEODETIC SURVEY BRASS DISK IN CONCRETE, STAMPED "0+00"
- 1+50  
N. 667914.556 (N. 667915.150)  
E. 1771056.578 (E. 1771066.076)  
SET 3-1/2" NATIONAL GEODETIC SURVEY BRASS DISK IN CONCRETE, STAMPED "1+50"
- 4+20  
N. 667966.228 (N. 667966.823)  
E. 1771321.568 (E. 1771321.066)  
SET 3-1/2" NATIONAL GEODETIC SURVEY BRASS DISK IN CONCRETE, STAMPED "4+20"
- 10+00  
N. 668077.325 (N. 668077.918)  
E. 1771890.792 (E. 1771890.290)  
SET 3-1/2" NATIONAL GEODETIC SURVEY BRASS DISK IN CONCRETE, STAMPED "10+00"

NOTE: COORDINATES ARE BASED ON THE NORTH AMERICAN DATUM OF 1983. EPOCH 1991.35. COORDINATES IN PARENTHESES ARE BASED ON THE NORTH AMERICAN DATUM OF 1983. EPOCH 2007 AND SHOWN AS INFORMATIONAL ONLY.

## VICINITY MAP

NOT TO SCALE

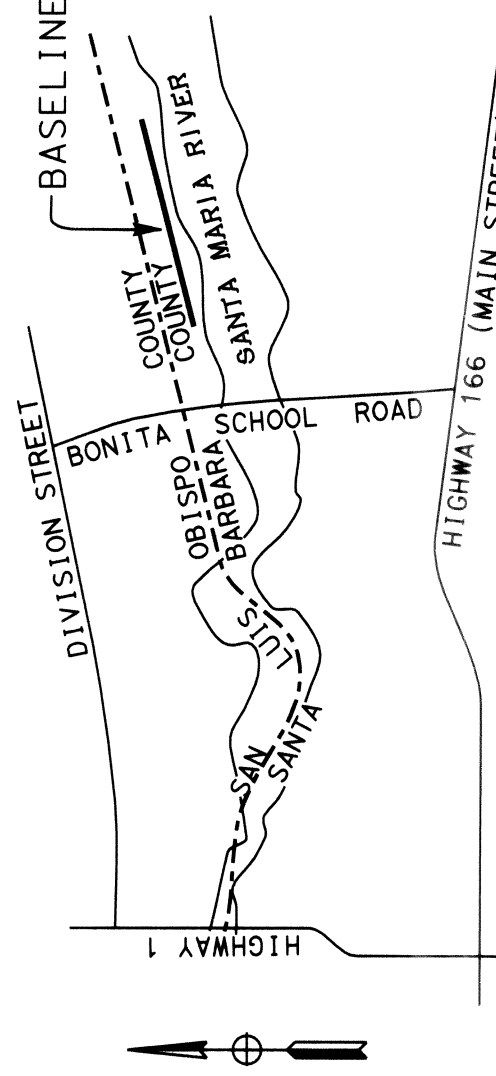

## SURVEYOR'S STATEMENT

THIS MAP CORRECTLY REPRESENTS A SURVEY MADE BY ME OR UNDER MY DIRECTION IN CONFORMANCE WITH THE REQUIREMENTS OF THE PROFESSIONAL LAND SURVEYORS' ACT AT THE REQUEST OF THE DEPARTMENT OF TRANSPORTATION IN MAY AND AUGUST 2008.

*Robert C. Fredricks*  
ROBERT C. FREDRICKS  
L.S. NO. 6779  
LICENSE EXPIRATION DATE: 09/30/10



## COUNTY SURVEYOR'S STATEMENT

THIS MAP HAS BEEN EXAMINED IN ACCORDANCE WITH SECTION 8766 OF THE PROFESSIONAL LAND SURVEYORS' ACT THIS 17th DAY OF February, 2009.

*Michael B. Emmons*  
MICHAEL B. EMMONS  
COUNTY SURVEYOR  
L.S. NO. 5899  
LICENSE EXPIRATION DATE: 12/31/10



## RECORDER'S STATEMENT

FILED THIS 18 DAY OF February, 2009 AT 11:10 O'CLOCK A.M. IN BOOK 176 OF RECORDS OF SURVEYS AT PAGES 29 AT THE REQUEST OF THE STATE OF CALIFORNIA DEPARTMENT OF TRANSPORTATION.  
FEE: NO FEE PURSUANT TO GOVERNMENT CODE 6103.

JOSEPH E. HOLLAND  
COUNTY CLERK - RECORDER - ASSESSOR  
*Joseph E. Holland*  
DEPUTY COUNTY CLERK

## LEGEND

- ▲ - FOUND PRIMARY PROJECT CONTROL MONUMENT AS DESCRIBED
- △ - FOUND SECONDARY PROJECT CONTROL MONUMENT AS DESCRIBED
- ⊙ - SET 3-1/2" NATIONAL GEODETIC SURVEY BRASS DISK IN 1 FOOT DIAMETER CONCRETE STAMPED "CALIBRATION BASELINE"
- R - RECORD REFERENCE
- M - MEASURED
- m - METERS

**BASELINE SITE ACCESS:**  
ACCESS TO THE BASELINE SITE SHALL BE OBTAINED BY PERMISSION THROUGH THE COUNTY OF SANTA BARBARA. A KEY TO THE ACCESS GATE WILL BE AVAILABLE AT:  
COUNTY OF SANTA BARBARA  
PUBLIC WORKS SERVICE CENTER  
620 WEST FOSTER ROAD  
SANTA MARIA, CA.  
(805) 568-3440

## REFERENCE DATA:

- R1 - NATIONAL GEODETIC SURVEY DATA SHEETS
- R2 - RECORD OF SURVEY BK 147 PG 57-61, SANTA BARBARA COUNTY RECORDER'S OFFICE

SCALE FACTOR: 1

TO OBTAIN GROUND LEVEL DISTANCES MULTIPLY BY 1.000070804

STATE OF CALIFORNIA  
BUSINESS AND TRANSPORTATION AGENCY  
DEPARTMENT OF TRANSPORTATION  
DISTRICT 5, SAN LUIS OBISPO

## CALIBRATION BASELINE IN

## SANTA BARBARA COUNTY

COUNTY	ROUTE	POST MILE	SHEET TOTAL
SB	166	3.74	1